



**20921 COUNTY ROAD 33
LASALLE, CO 80631**

Space Available

9,600 SF

Sale Price:

\$2,250,000

\$ / SF:

\$234.38 / SF

Lot Size:

Approx. 3.5 acres

UNINCORPORATED WELD COUNTY INDUSTRIAL PROPERTY WITH LARGE YARD

- Consists of entry area, private office, restroom, and warehouse space with (2x) 14ft OH doors
- Located in unincorporated Weld County
- Easy US 85 access
- 3.5 acre parcel
- Large yard
- Power: 480v 1000amp electric
- (2x) 14 ft overhead doors

**FOR SALE
EASY US 85 ACCESS
480V 1000 AMP ELECTRIC
UNINCORPORATED WELD
COUNTY
3.5 ACRE PARCEL**



FLOORPLAN

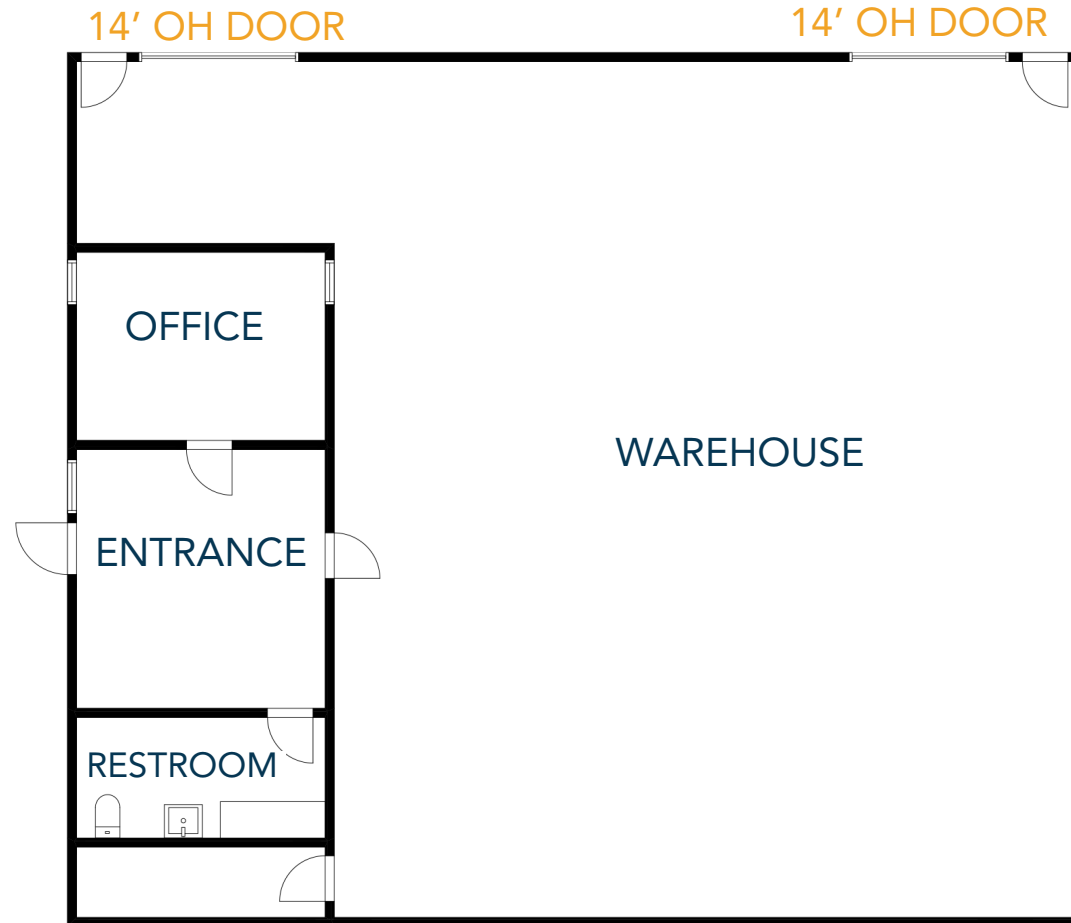

PROPERTY PHOTOS



EXTERIOR PHOTOS





Information contained herein is not guaranteed. Potential land purchasers and tenants are advised to verify all information. Price, terms and information are subject to change.

CONTACT: Brian Smerud, CCIM • 970-415-0538 • bsmerud@waypointRE.com
Erik Caffee • 970-218-4284 • ecaffee@waypointRE.com