

ST. MICHAELS CLOCKTOWER

3050 67TH AVENUE
GREELEY, CO 80634



waypoint
REAL ESTATE

Available
Space

#100 1,846 SF
#103 1,500 SF

Lease Rate

\$17.75 / SF NNN

NNN Rate

\$10.60 / SF

2023 estimate

DESIRABLE OFFICE SPACE FOR LEASE IN A GROWING COMMERCIAL CENTER

- Two large professional offices available in a prime location
- Private offices, conference rooms, restrooms, breakroom and more
- Abundance of parking for tenants and customers
- Traffic Counts 36,097 per day at Highway 34
- Adjacent to UCHealth Greeley Hospital
- Large windows for abundant natural light
- Quick access to Highway 34



FLOORPLAN

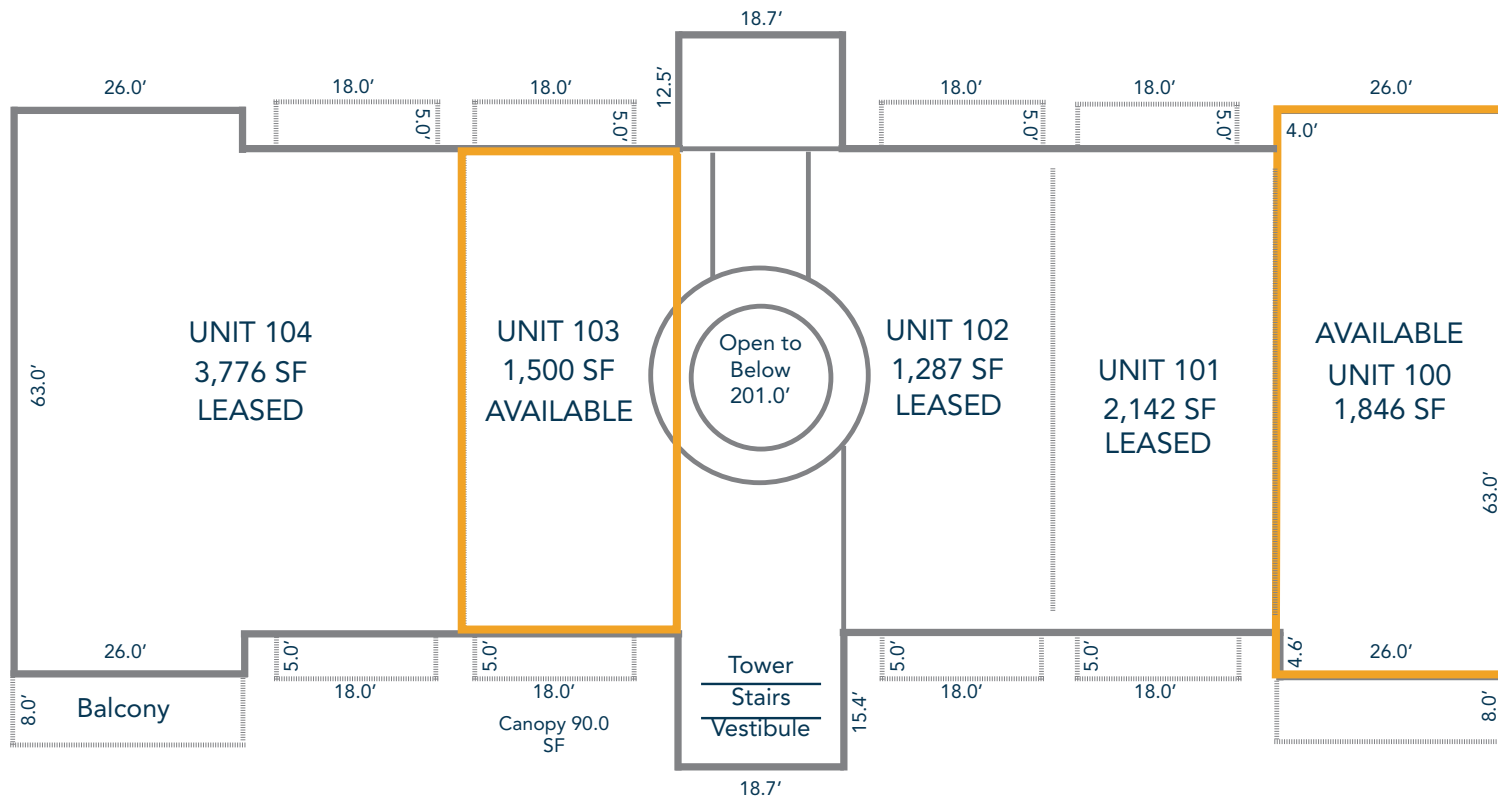

PROPERTY OVERVIEW

St. Michaels Clocktower Office building is a multi-tenant office property in Greeley, CO. It is ideally located in the St. Michaels development of fast-growing west Greeley at US Highway 34 and 65th Avenue. Demand for office in this area of Greeley is driven by UHealth's west Greeley Hospital. The hospital opened in 2019, is approximately 212,000 SF, and has 91 beds. In addition, UHealth has built a medical office adjacent to the hospital. The UHealth campus is a major value generator for the area and should continue to drive demand for all types of commercial use, which should drive rents higher in the area.

GREELEY OVERVIEW

- Third fastest growing MSA in the nation
- Greeley/Fort Collins region projected to grow by over 100% over the next 30 years.
- Forbes magazine ranks Greeley MSA the 6th fastest "job growth" market in the nation
- Ranked #1 by WalletHub for "Jobs and the Economy" out of 515 cities nationally.

PROPERTY PHOTOS



AREA MAP



CONTACT: Brian Smerud, CCIM • 970-415-0538 • bsmerud@waypointRE.com
Jake Arnold • 970-415-0538 • jarnold@waypointRE.com

BRIAN SMERUD, CCIM / JAKE ARNOLD
125 S Howes Street Suite 500, Fort Collins, CO 80521 • 970-632-5050 • www.waypointRE.com