

706, 710, 716 12TH ST.  
GREELEY, CO 80631

FENCED OUTSIDE YARD

GREAT DOWNTOWN  
LOCATON

RETAIL/INDUSTRIAL/  
FLEX



Space  
Available:

706 12th St: 3,000 SF

710 12th St: 5,700 SF

716 12th St: 5,000 SF

Total Space: 13,700 SF

Lease Rate:

\$17.00/SF NNN

NNN Rate:

\$6.00 / SF

*MULTIPLE FLEX/INDUSTRIAL/RETAIL BUILDINGS FOR LEASE SEPARATELY OR TOGETHER*

- Flex buildings with warehouse space, retail space, multiple offices, private restrooms, 5 overhead doors and fenced outside yard - see below for individual building layouts
- Located in fast growing and developing downtown Greeley, surrounded by retail and restaurant amenities
- Onsite and street parking
- Building signage



# FLOORPLAN

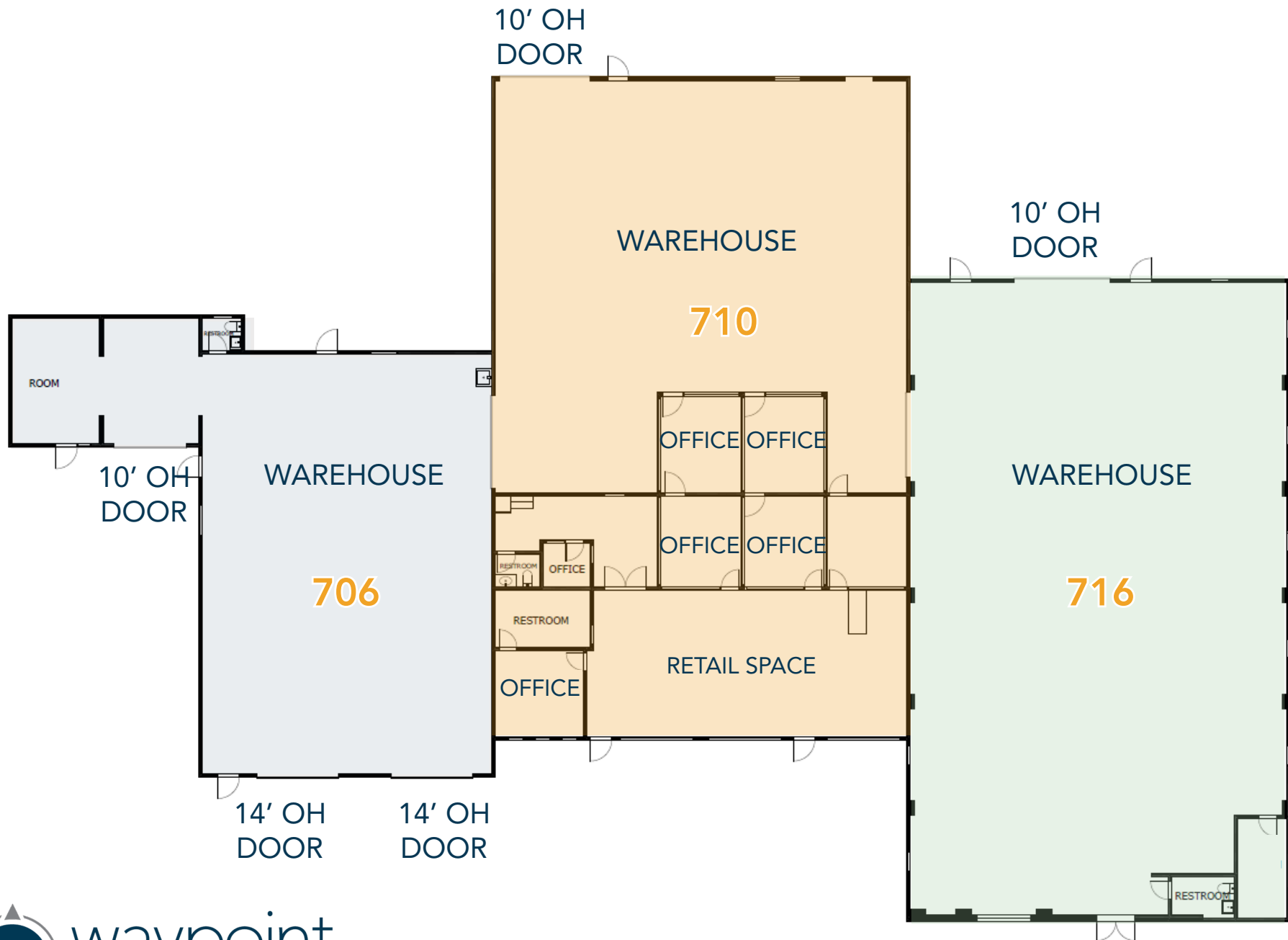



# AERIAL PHOTOS





# 706 12TH ST PHOTOS





# 710 12TH ST PHOTOS





# 716 12TH ST PROPERTY PHOTOS





# AERIAL MAP

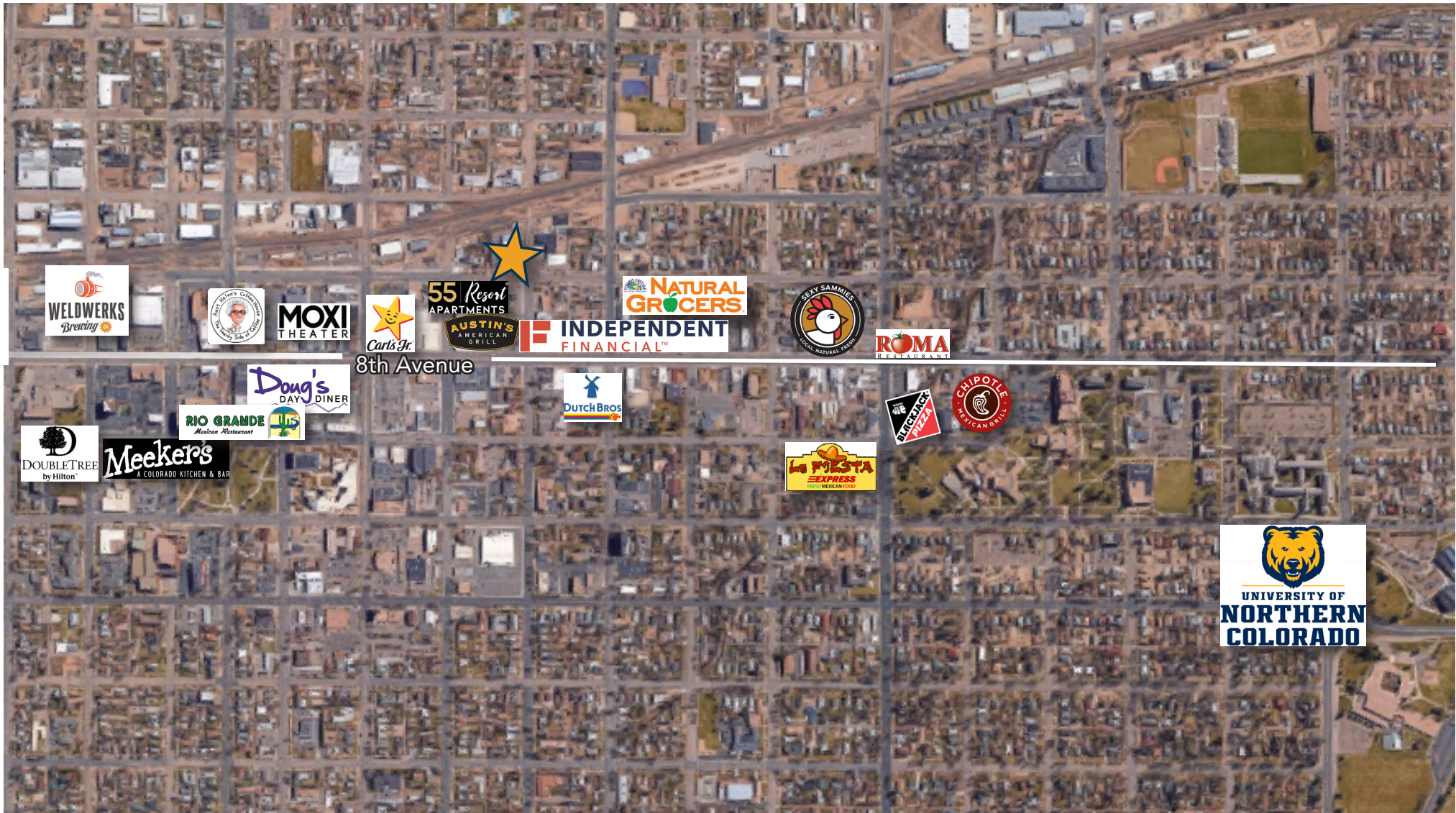



# LOCAL MAP



**CONTACT:** Brian Smerud, CCIM • 970-415-0538 • [bsmerud@waypointRE.com](mailto:bsmerud@waypointRE.com)  
Erik Caffee • 970-218-4284 • [ecaffee@waypointRE.com](mailto:ecaffee@waypointRE.com)



BRIAN SMERUD, CCIM / ERIK CAFFEE  
125 S Howes St., Suite 500, Fort Collins, CO 80521 • 970-632-5050 • [www.waypointRE.com](http://www.waypointRE.com)