



BOOK OF DESIGNS:

Outdoor Kitchens

 **ClifRock**

COYOTE
Outdoor Living



Table of Contents

Space/Appliances/Structure | **3-5**

S-Series/S5-10/S Hybrid/Cold Bar | **6-15**

L-Series/L15/L17.5/L20 | **16-22**

U-Series/U25/U37.5 | **23-25**

Authorized Installers | **26**

1 SPACE CONFIGURATION

Outdoor kitchens have become a fixture in the backyard. When building, you want to consider the size of your patio, deck or space where your outdoor kitchen will be located. It is important to make sure that the outdoor kitchen footprint is proportional to your space - providing enough room to walk around and congregate. The three most common outdoor kitchen configurations are Straight (S-Series), L-Shape (L-Series) and U-Shape (U-Series). The following Standard Layout and Options guide combines these configurations with different appliance packages.

STRAIGHT ISLAND

S-Series

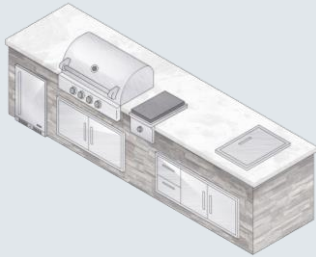

Straight outdoor grill stations or islands are perfect for small spaces. They can be built on patio's perimeter or along an existing exterior wall. You can also add a detached, parallel bar or refreshment station.

L-SHAPE BAR-ISLAND

L-Series



L-Shape outdoor kitchen/bar-islands, similar to a Straight island can work well in small to medium size spaces and can be located on perimeter of a patio. L-Shape layouts are a great way to add convenient prep and bar space.

U-SHAPE KITCHEN

U-Series



U-Shape outdoor kitchens are the ultimate in prepping, cooking and entertaining outside. A U-Shape requires a medium to large space. The U-Shape also offers convenience of all appliances, utilities and components in one place.

2 GRILLS & APPLIANCES



The Outdoor Kitchen is the “heart” of the Outdoor Room and a key component in outdoor entertaining and leisure. Your outdoor kitchen addition should be well thought out. What will be the typical usage? How many people will use it on a regular basis? When entertaining guests, how many people will you need to feed? Having the right grill and appliances is essential to getting optimal use and enjoyment out of your outdoor kitchen space. Please find description’s below of our silver, gold and platinum packages.

SILVER PACKAGE

Built for value and utility with room for adding onto later. The Silver Package is a great way to start enjoying an outdoor kitchen without breaking your bank while giving you the flexibility to upgrade* in the future.

- Cooking, Preparation and Storage Space standard features
- Refrigerators equipped in larger L and U Shapes

GOLD PACKAGE

Offers value, upgraded features and overall best bang for the buck by providing more cooking, storage and refrigeration spaces. The Gold package is designed to be fully expandable down the road.

- Cooking, Refrigeration Preparation and Storage Space standard
- Multiple Cooking surfaces
- Additional Storage equipped in larger S, L and U Shapes

PLATINUM PACKAGE

Offers all the bells and whistles of a custom outdoor kitchen without the custom price. The Platinum Package is designed to optimize the outdoor kitchen island/bar space for functionality and enjoyment.

- Cooking, Refrigeration Preparation and Storage Space standard features
- Multiple Cooking surfaces in most
- Additional Storage equipped in larger S, L and U Shapes

A letter from Coyote Outdoor Living:

Coyote Outdoor Living’s passion for design, value and the outdoor lifestyle is demonstrated in our outdoor culinary and entertainment products. All of our grills are built with premium grade 304 stainless steel throughout and have features such as double-walled stainless steel hoods, cast stainless steel burners and zinc nickel alloy knobs. We are proud to offer durable products at great values so we can enable all outdoor chefs and enthusiasts to build the outdoor kitchen of their dreams.

COYOTE
Outdoor Living



3 STRUCTURE DESIGN

It is important to consider the environmental stress and climate, when building the outdoor kitchen structure to house your grill, appliances and storage. Using materials engineered for the outdoors is critical to long term durability and enjoyment. Additionally, you will want to consider an aesthetic look that will compliment your existing landscape and home. Our kitchens come in several timeless stone profiles; Ledge Stack, Dry Stack and Random Rock with a number of different color options.

STONE STYLES



Ledge Stone



Dry Stack Stone



Random Rock

Color Options

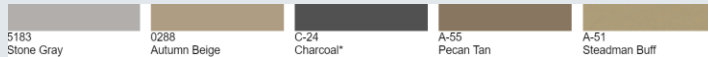

ClifRock Panel Masonry Technology™

ClifRock Engineered Stone Panels provide the traditional look of stone without the added cost or property disruption. ClifRock offers a frameless panel system made from a polymeric, fiber reinforced, high-performance concrete ensuring strength and performance under extreme environmental stresses. ClifRock panel system was designed and engineered to be a faster, simpler and more efficient way to build outdoor kitchen structures.

S-SERIES OUTDOOR KITCHEN



5ft Outdoor Grill Island Series: The ideal solution for smaller spaces while making the perfect grill station. The 5ft Series can be paired with a Kamado Station and/or a separate Bar-Refreshment Station. For the budget conscious it can also be added down the road.



SILVER 5ft S

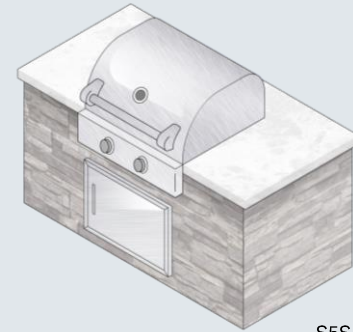

S5S

DESCRIPTION

5' W x 30" D outdoor kitchen grill island with a centered 28" Coyote grill and single access door

APPLIANCES

> 28" C-Series
> CSA1724



S5-SERIES



GOLD 5ft S Option A

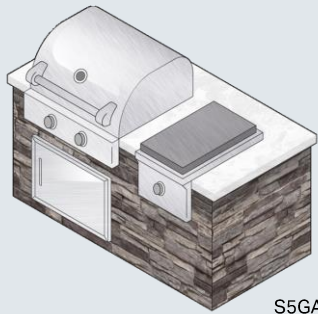

S5GA

DESCRIPTION

5' W x 30" D outdoor kitchen island with a left justified 28" Coyote grill with a single access door and single side burner

APPLIANCES

- > 28" C-Series
- > CSA1724
- > C1SB



GOLD 5ft S Option B

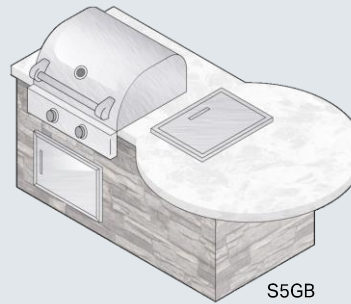

S5GB

DESCRIPTION

5' W x 30" D outdoor kitchen island with a rounded bar top, a left justified 28" Coyote grill with single access door and drop-in cooler

APPLIANCES

- > 28" C-Series
- > CSA1724
- > CDIC



Coyote C-Series 28" Grill offers two high performance Coyote Infinity Burners™ and 640 sq. in. cooking area, (up to 40,000 BTU), interior grill light, and complete 304 stainless construction.

COYOTE
Outdoor Living

S5-SERIES

The Platinum Package offers a 34" or 36" Coyote Grill and standard built-in refrigeration.



Platinum 5ft S

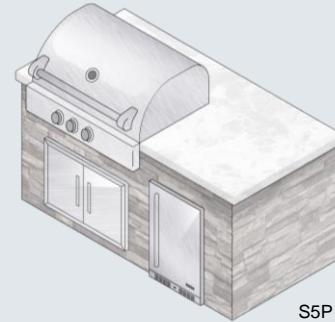

S5P

DESCRIPTION

5' W x 30" D outdoor kitchen island with a left justified 34" Coyote grill, double access door, and refrigerator

APPLIANCES

- > 34" C-Series
- > CDA2431
- > CBIR



S7.5-SERIES



The 7.5 ft Outdoor Kitchen Series provides more preparation, cooking and cabinet space. The 7.5 ft Series can be paired with a Kamado Station and/or a separate Bar-Refreshment Station.



Silver 7.5ft S

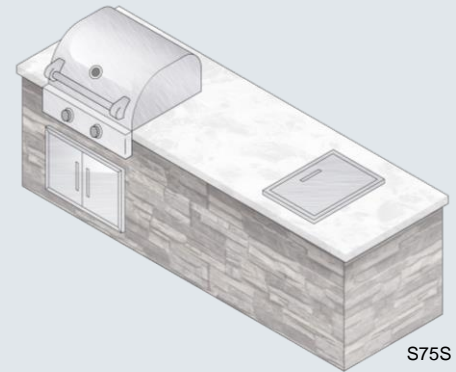

S75S

DESCRIPTION

7.5' W x 30" D outdoor kitchen island with a left justified 28" Coyote grill, double access door, and drop-in cooler

APPLIANCES

- > 28" C-Series
- > CDA2431
- > CDIC



S7.5-SERIES

GOLD 7.5FT S

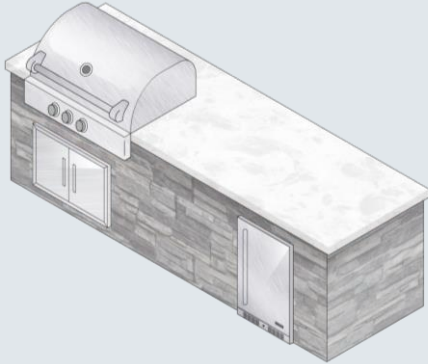

S75G

DESCRIPTION

7.5' W x 30" D outdoor kitchen island with a left justified 34" Coyote grill, double access door, and built-in refrigerator

APPLIANCES

- > 34" C-Series
- > CDA2431
- > CBIR



Platinum 7.5FT S

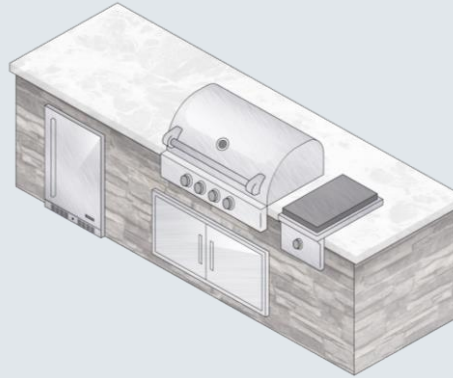

S75P

DESCRIPTION

7.5' W x 30" D outdoor kitchen island with a centered 36" SL-Coyote grill, double access doors, single side burner, and built-in refrigerator

APPLIANCES

- > 36" SL-Series
- > CDA2439
- > C1BR24
- > C1SB



Most Platinum packages come with an upgraded Coyote S-Series 36" grill, which offers three high performance Coyote Infinity Burners™ plus one Coyote RapidSear™ infrared burner and 875 sq. in. cooking area, (up to 90,000 BTU), interior grill lighting, LED illuminated knobs and complete 304 stainless construction.

S7.5-SERIES



Hybrid 7.5ft S



S75H

Description

7.5' W x 30" D x 40" H outdoor kitchen island with a centered 50" Coyote hybrid (gas/charcoal) grill and combo drawers

Appliances

- > 50" Grill CIHY
- > CCD-POD



The outdoor cooking enthusiast grilling dream kitchen island – the Coyote 50" hybrid grill combines the convenience of a gas grill with the flavor option of charcoal.

REFRESHMENT & COLD BAR



REFRESHMENT ISLAND



S5RC

DESCRIPTION

5' refreshment island with a Coyote refreshment center and single access door

Appliances

- > CRC
- > CSA1724



COLD BAR ISLAND



S5CB

DESCRIPTION

5' cold bar island with a Coyote built-in refrigerator and drop-in cooler

APPLIANCES

- > CDIC
- > CBIR



S10-SERIES



SILVER 10ft S

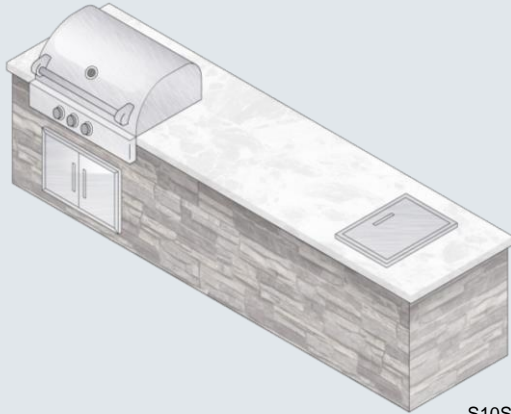

S10S

DESCRIPTION

10' W x 30" D outdoor kitchen island with a left justified 34" Coyote grill, double access door and drop-in cooler

APPLIANCES

- > 34" C-Series
- > CDA2431
- > CDIC

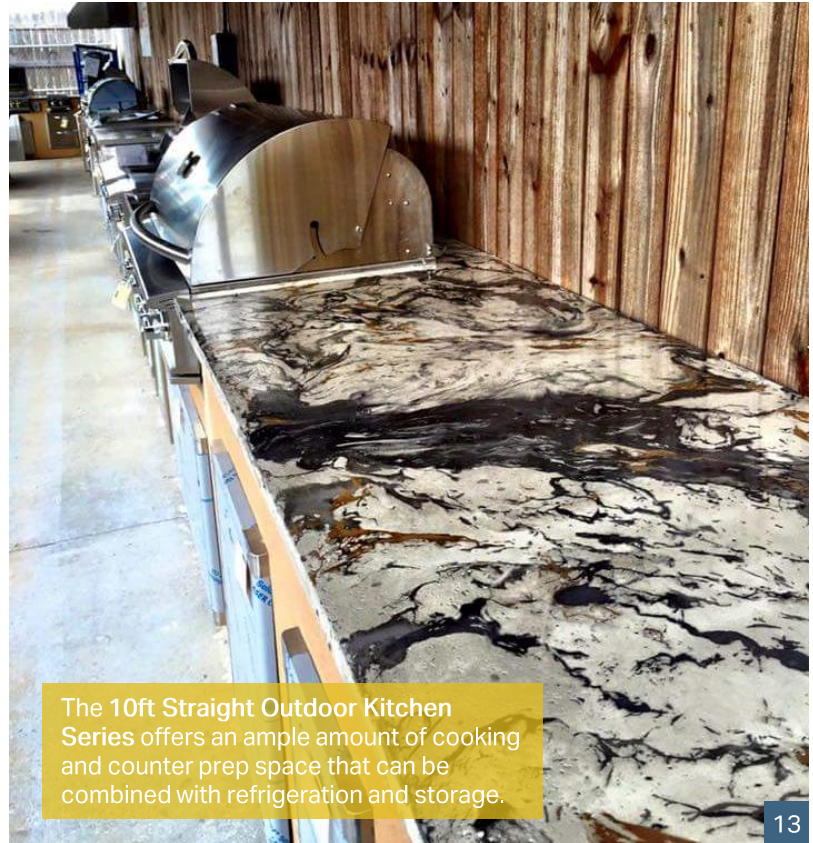

The 10ft Straight Outdoor Kitchen Series offers an ample amount of cooking and counter prep space that can be combined with refrigeration and storage.

S10-SERIES



GALLEY KITCHEN

Building your outdoor kitchen in phases is a great way to expand your outdoor living space over time while staying within your budget. One popular method is adding a refreshment center or bar island running parallel with your outdoor kitchen island.



GOLD 10ft S

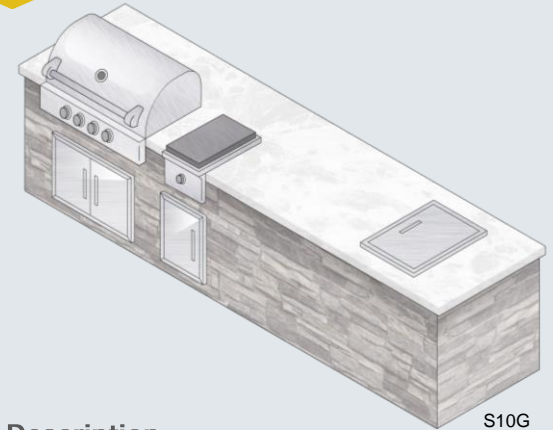

S10G

Description

10' W x 30" D outdoor kitchen island with a left justified 36" Coyote grill, double access doors, single side burner and drop-in cooler

APPLIANCES

- > 36" C-Series
- > CDA2431
- > C1SB
- > CSA2417
- > CDIC



S10-SERIES



PLATINUM 10ft S

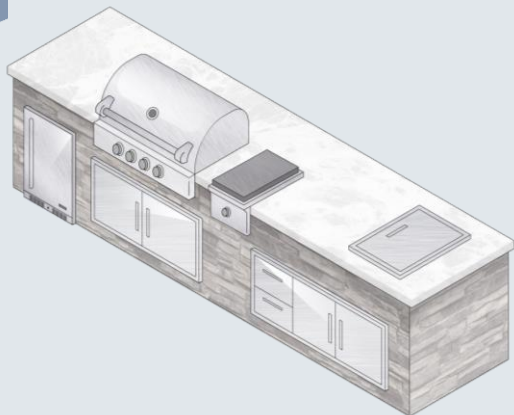

DESCRIPTION

10' W x 30" D outdoor kitchen island with a centered 36" SL-Coyote grill, double access doors, single side burner, combo drawers, ice chest and built-in refrigerator

APPLIANCES

- > 36" SL-Series
- > CDA2439
- > CCD-2CD
- > C1SB
- > CDIC
- > C1BR24



KAMADO ATTACHMENT

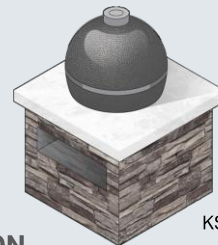

KSB

DESCRIPTION

30" W x 30" D x 30" H kamado station with vent opening

APPLIANCE

- > C1CHCS (Asado Cooker)



CHARCOAL SMOKERS

For the outdoor cooking enthusiasts who appreciate how charcoal grilling and smoking can almost seem poetic.. the slow cooking, the natural smells; it is truly a culinary art form. Coyote Outdoor Living's Asado cooker brings this art form to life.

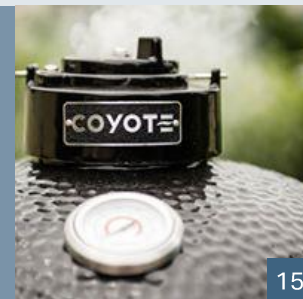



L-SERIES OUTDOOR KITCHEN



L15-SERIES



SILVER 15ft L

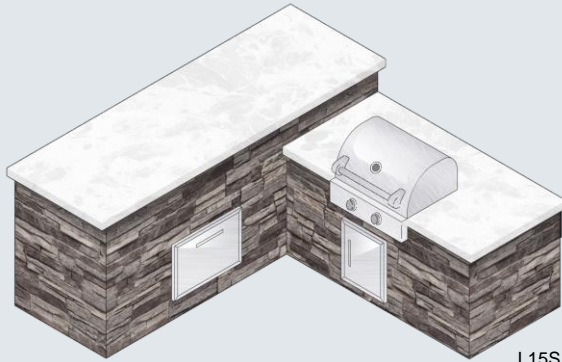

L15S

DESCRIPTION

7.5' x 7.5' outdoor kitchen with both bar and counter heights, centered 28" Coyote grill, single access door and pull-out ice chest

APPLIANCES

- > 28" C-Series
- > CSA2417
- > CPOC



GOLD 15ft L

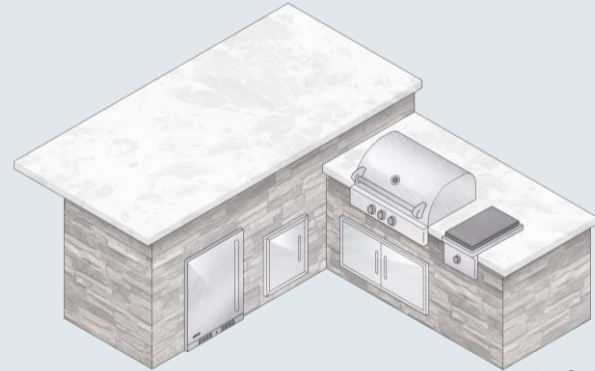

L15G

DESCRIPTION

7.5' x 7.5' outdoor kitchen with a 12" counter bar overhang, 34" Coyote grill, single side burner, double and single access doors, and built-in refrigerator

APPLIANCES

- > 34" C-Series
- > CDA2439
- > CSA2417
- > CBIR



L15-SERIES



Platinum 15ft L

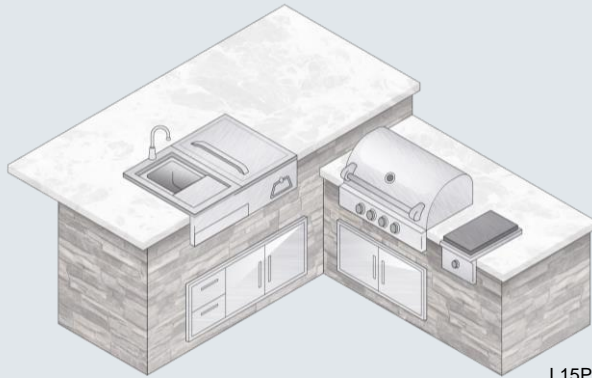

L15P

DESCRIPTION

7.5' x 7.5' outdoor kitchen with a 12" bar counter overhang, 36" Coyote grill, single side burner, double access doors, combo drawers and refreshment center

APPLIANCES

- > 36" SL-Series
- > CDA2439
- > CCD-2DC
- > C1SB
- > CRC



REFRESHMENT CENTER

When designing and building your outdoor kitchen, you want to consider your food prep and serving needs. The Coyote refreshment center includes several key amenities to make your outdoor kitchen fully functional – key features include a sink, cutting board, drop-in cooler, condiment tray and a convenient bottle shelf, towel holder and bottle opener.



L17.5-SERIES



SILVER 17.5ft L

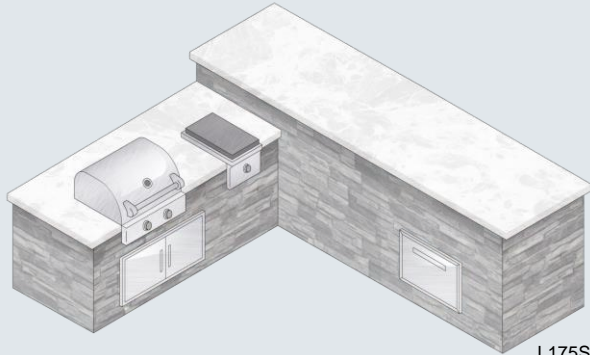

L175S

DESCRIPTION

7.5' x 10' outdoor kitchen with a bar and counter height structure, 28" Coyote grill, single side burner, double access doors and pull out ice chest

APPLIANCES

- > 28" C-Series
- > CDA2439
- > C1SB
- > CPOC



GOLD 17.5ft L

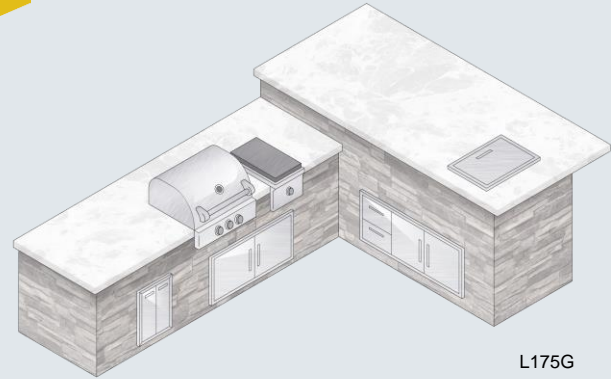

L175G

DESCRIPTION

7.5' x 10' outdoor kitchen with a 12" bar counter overhang, 34" Coyote grill, single side burner, double access doors, combo drawers, drop-in cooler and dual pull-out trash/recycle

APPLIANCES

- > 34" C-Series
- > C1SB
- > CTC
- > CDA2439
- > CCD-2DC
- > CDIC



L17.5-SERIES



PLATINUM 17.5ft L

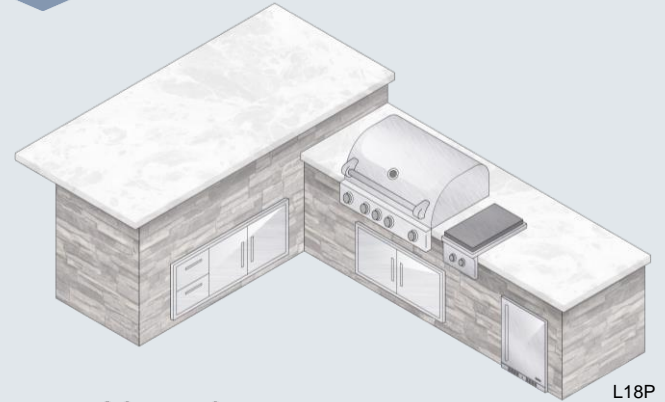

L18P

DESCRIPTION

7.5' x 10' outdoor kitchen with a 12" bar counter overhang, 36" Coyote grill, double side burner, double access doors, combo drawers and 24" built-in refrigerator

APPLIANCES

- > 36" SL-Series
- > CDA2439
- > C1BIR24
- > C1DB
- > CCD-2DC



L20-SERIES



SILVER 20ft L

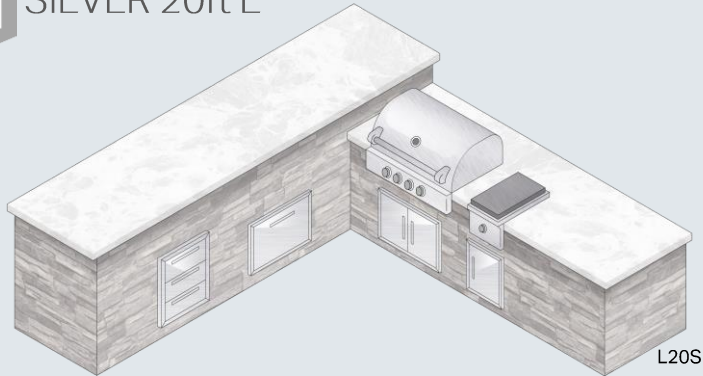

DESCRIPTION

10' x 10' outdoor kitchen with bar and counter height structures, centered 34" Coyote grill, single burner, double and single access doors, three drawer cabinet and pull-out ice chest

APPLIANCES

- > 34" C-Series
- > CDA2431
- > CSA2417
- > C1SB
- > CPOC
- > C3DC



L20-SERIES



Gold 20ft L



L20G

DESCRIPTION

10' x 10' outdoor kitchen with a 12" bar counter overhang, 36" Coyote grill, single side burner, double and (2) single access doors, combo drawers and built-in refrigerator

APPLIANCES

- > 36" C-Series
- > CDA2431
- > C1SB
- > CBIR
- > CSA2417 (2)
- > CCD-2DC31



Platinum 20ft L



L20P

DESCRIPTION

10' x 10' outdoor kitchen with 12" bar counter overhang, 36" Coyote grill, double side burner, double and single access doors, pull-out ice chest, refreshment center and 24" built-in refrigerator

APPLIANCES

- > 36" SL-Series
- > CDA2431
- > C1DB
- > CRC
- > CPOD
- > C1BR24
- > CCD-2DC31





U-SERIES OUTDOOR KITCHEN



U-SERIES OUTDOOR KITCHEN

If your space and budget allow, the U-Series is the ideal outdoor kitchen configuration for storage, convenience and entertainment. With a U-Shape kitchen you can easily grill and converse while having all of the amenities of an indoor kitchen.

U25-SERIES



SILVER 25ft U

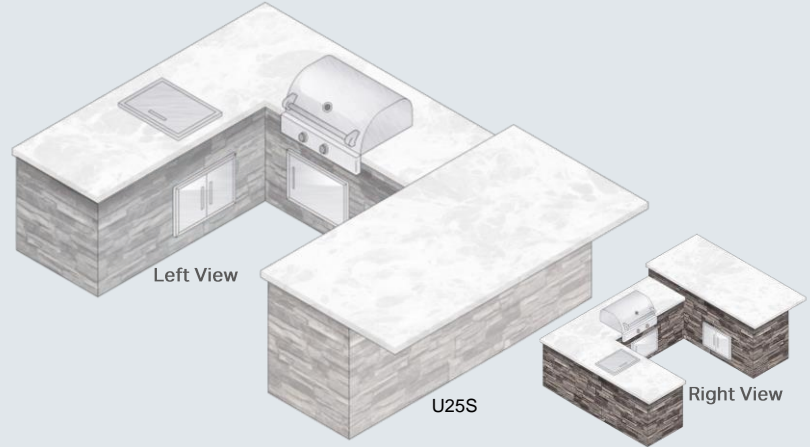

DESCRIPTION

7.5' x 10' x 7.5' u-shape outdoor kitchen with 12" bar overhang, 28" coyote grill, (2) double and single access doors, and a drop-in cooler

APPLIANCES

- > 28" C-Series
- > CSA1724
- > CDA2431(x2)
- > CDIC



U25-SERIES



GOLD 25ft U

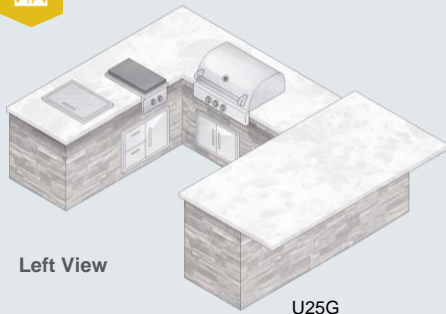

U25G



DESCRIPTION

7.5' x 10' x 7.5' U-Shape outdoor kitchen with 12" bar height overhang. 34" Coyote grill, single burner, double access doors, combo drawers, drop-in cooler and built-in refrigerator

APPLIANCES

- > 34" C-Series
- > CDA2431
- > CCD-2DC31
- > C1DB
- > CDIC
- > CBIR



U37.5-SERIES



Platinum 37.5ft U

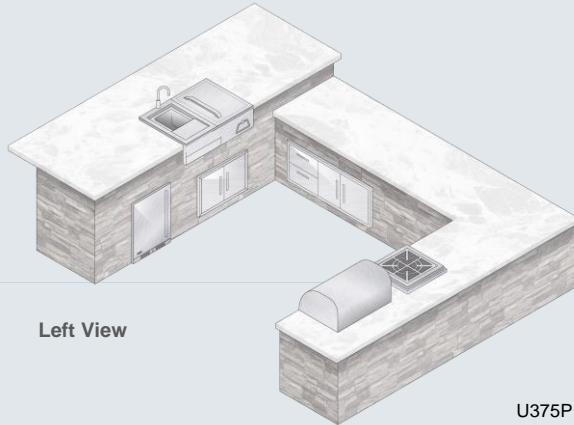

Left View

U375P

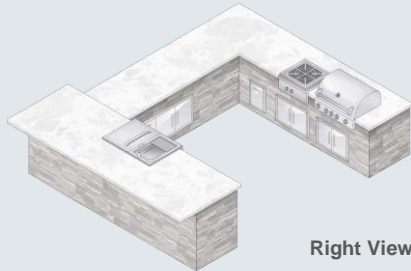

Right View

DESCRIPTION

10' x 17.5' x 10' U-Shape outdoor kitchen with 12" bar height overhang, 36" Coyote grill, power burner, (2) double access doors, combo drawers, pull-out ice chest, entertainment center and 24" built-in refrigerator

APPLIANCES

- > 36" SL-Series
- > CDA2431(2)
- > C1PB
- > CPOD
- > CCD-2DC
- > CRC
- > CIBR24



CERTIFIED INSTALLERS



ClifRock Installer: David and Tabitha Forster, Monumental Outdoor



Pro Installers

ClifRock Outdoor Living Construction System is only available through local contractors that are factory qualified, trained and authorized to offer, design and install. You can rest assured you are in the hands of a professional and our product is backed by a full structural warranty.

For more info visit |
www.ClifRock.com/installer



As Seen On

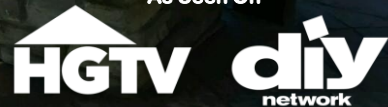

 **ClifRock**

COYOTE
Outdoor Living

4 Center St
Merrimack, NH 03054
(603) 792-3466

2615 E Belt Line Rd Ste 160
Carrollton, TX 75006
(855) 520-1559