

Item	Description	HP Part No.	Qty.
1	Screw, M3 x 6 mm	0515- 0924	4
2	Screw, M4 x 8 mm	0515- 0910	13
3	NPD Cover	19234- 80020	1
4	Connector	1251- 8328	1
5	Cable	8120- 2277	1
6	Set Screw	0515- 0117	3
7	Contact	19234- 20610	1
8	Insulator	19234- 20600	1
9	NPD Body Assembly	19234- 80510	1
10	Gasket	0905- 0915	1
11	Toroid/Spacer Assembly	19234- 60640	1
12	● Toroid Assembly	19234- 60580	1
13	● Toroid Seat	4040- 2120	2
14	O- Ring, Viton	0905- 1014	1
	package of 12	5180- 4182	-
15	Retainer Nut	19234- 20630	1
16	NPD Collector Assembly	19234- 60540	1
17	Jets:		
	● Packed Column (0.018- inch id)	18710- 20119	1
	● Simulated Distillation (0.030 inch id)	18789- 80070	1
	● Capillary Column (0.011 inch id)	19244- 80560	1
18	Contact Pin (P/O Toroid Assy)	19301- 21450	1
19	Side Shield	19231- 00100	2
20	Spanner Nut	19231- 20580	1
21	J- Clamp	19231- 00040	1
22	Thermal Strap	19231- 40050	1
23	Insulation Plate (Retainer)	19231- 00090	1
24	Insulation	19231- 00080	1
25	Detector Weldment	19231- 80580	1
26	Interconnect Assembly	19231- 60710	1
27	● Coil Spring	1460- 2142	1
28	Hex Nut, M3 x 0.5	0535- 0004	3
29	Lock Washer	2190- 0407	3
30	Heater/Sensor Assembly:	05890- 61140	1
31	● PRT Sensor	19231- 60660	1
32	● Contact	1251- 5963	2
33	● Heater, 70 W	19231- 60620	1
34	● Contact	1251- 1679	2
35	● Flexible Sleeving (ordered by the inch)	0890- 0737	22
36	Detector Adaptor (Refer to Figure 7)		1

Figure 3. Nitrogen Phosphorus Detector (NPD) (Sheet 1 of 2).

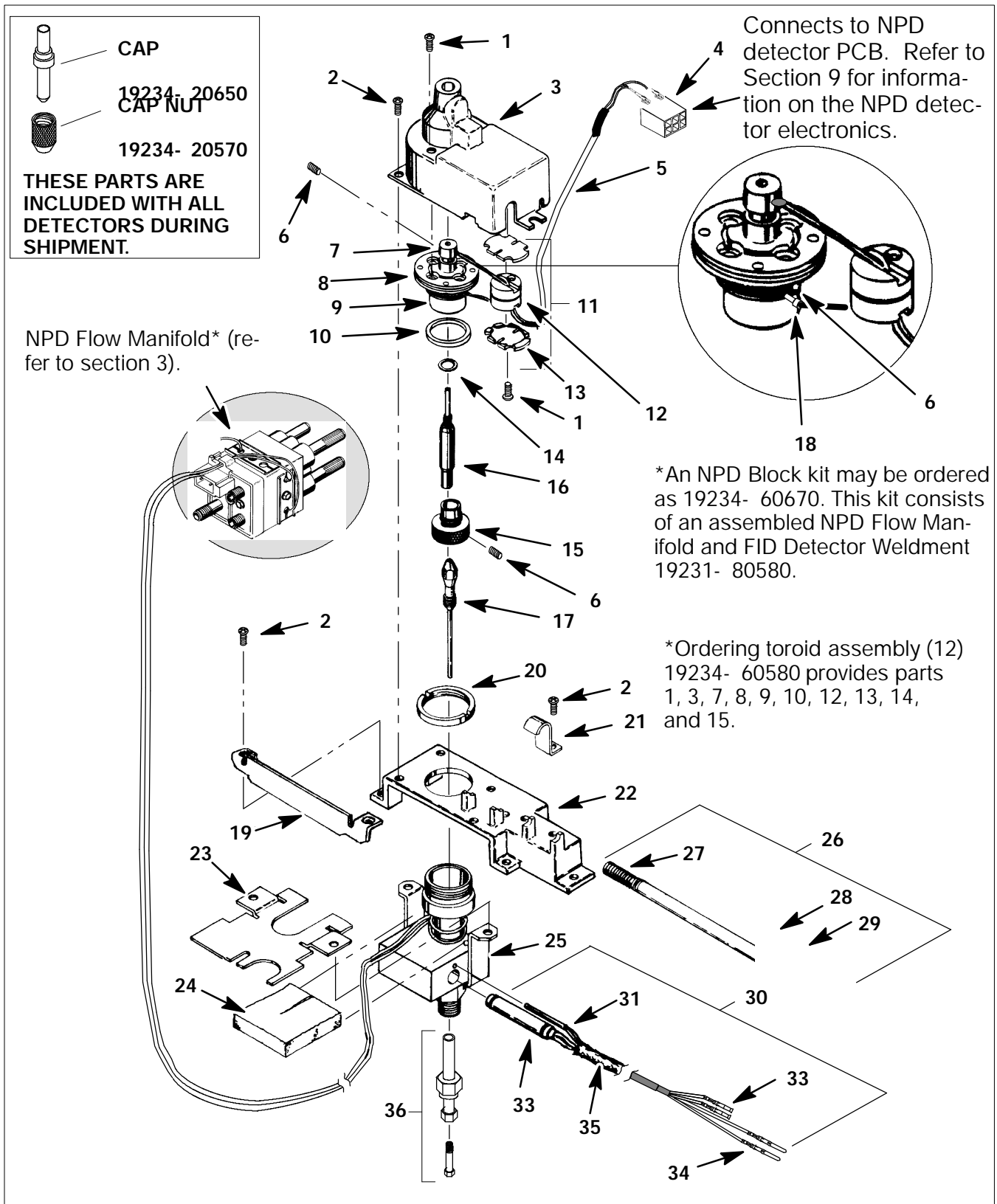

Figure 3. Nitrogen Phosphorus Detector (NPD) (Sheet 2 of 2).