

Replacement Parts and Supplies Model 4410 Flame-Ionization Detector (FID)

6890 Electrometer Connector Part number 252379

5890 part number is 193797

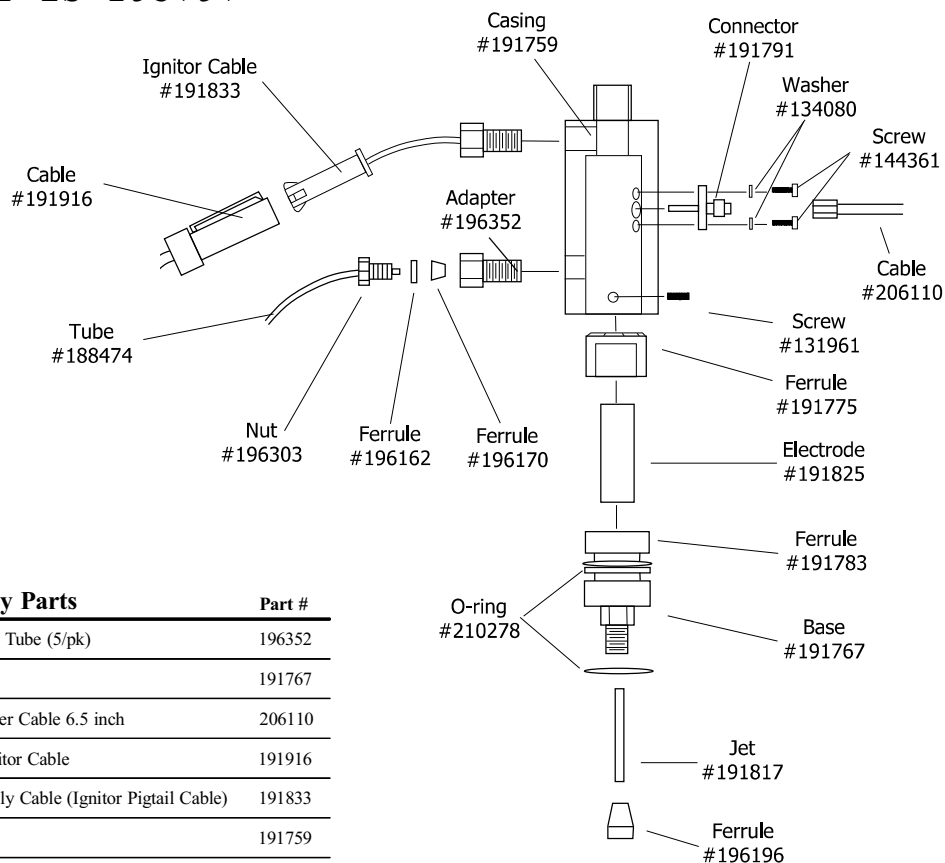

Model 4410 FID Assembly

Model 4410 FID Assembly Parts

	Part #
Adapter	1/16" Brass, Nickel Tube (5/pk) 196352
Base	FID Base 191767
Cable	Coaxial Electrometer Cable 6.5 inch 206110
Cable	Gas Module to Ignitor Cable 191916
Cable	Glow Plug Assembly Cable (Ignitor Pigtail Cable) 191833
Casing	FID Body Casing 191759
Connector	Coaxial Cable 191791
Electrode	Collector 191825
Ferrule	1/16" Brass Tube Back (5/pk) 196162
Ferrule	1/16" Brass Tube Front (5/pk) 196170
Ferrule	1/8" x 1/16" Graphite Tube (5/pk) 196196
Ferrule	Vespel Upper FID Body 191775
Ferrule	Vespel Lower FID Body 191783
Jet	1/16" O.D. x 0.3 mm I.D. Flame Jet 191817
Nut	1/16" Brass, Nickel Male (5/pk) 196303
O-ring	Viton Base (5/pk) 210278
Screw	Allen Set 6-32, 1/8" 131961
Screw	Machine 2-56, 3/16" Stainless Steel 144361
Tube	Stainless Steel Gas Module Output 188474
Washer	Lock Split Stainless Steel #2 134080

Model 4410 Miscellaneous Parts

	Part #
Cable	Analog Signal Cable (0-1 V) 185850
Cable	Ignitor Power Cable - Mother Board Gas Module 191866
Connector Assembly	Electrometer - Agilent 5890 193797
Kit	Gas Module PID/FID 2-line - Agilent 5890 192013
O-ring	Viton Manifold (12/pk) 185116
Standard	Detector 100 ppm 222919
Sub Assembly	FID 191742
Tube	Copper 1/8" x 0.070 mm I.D. 111427