

Item	Description	HP Part No.	Qty.
1	CGM Assembly	19247-60520	1
2	HP 5890A CGM Bracket	19247-00020	1
3	HP 5890A CGM Bracket	19247-00010	1
4	Screw, Pozidriv M4 x 45 mm (HP 5890A)	0515-0964	1
5	SS Hex Panel Nut (HP 5880A)	2950-0203	3
6	Screw, Self-tapping 8-16 x 3/4-inch (HP 5890A)	0624-0665	3
7	Front Ferrule, 1/8-inch T, brass	0100-0032	5
8	Back Ferrule, 1/8-inch T, brass	0100-0036	5
9	Tubing Nut, 1/8-inch T, brass	0100-0058	5
10	Tubing Tee Union, brass	0100-0090	1
11	Copper Tube, 48-inch	5020-8261	1
12	Copper Tube, 5-inch	5020-8275	2
- -	Installation Instructions (not shown)	19247-90150	1

Figure 9. Carrier Gas Miser (CGM), (HP19247B) (Sheet 1 of 2).

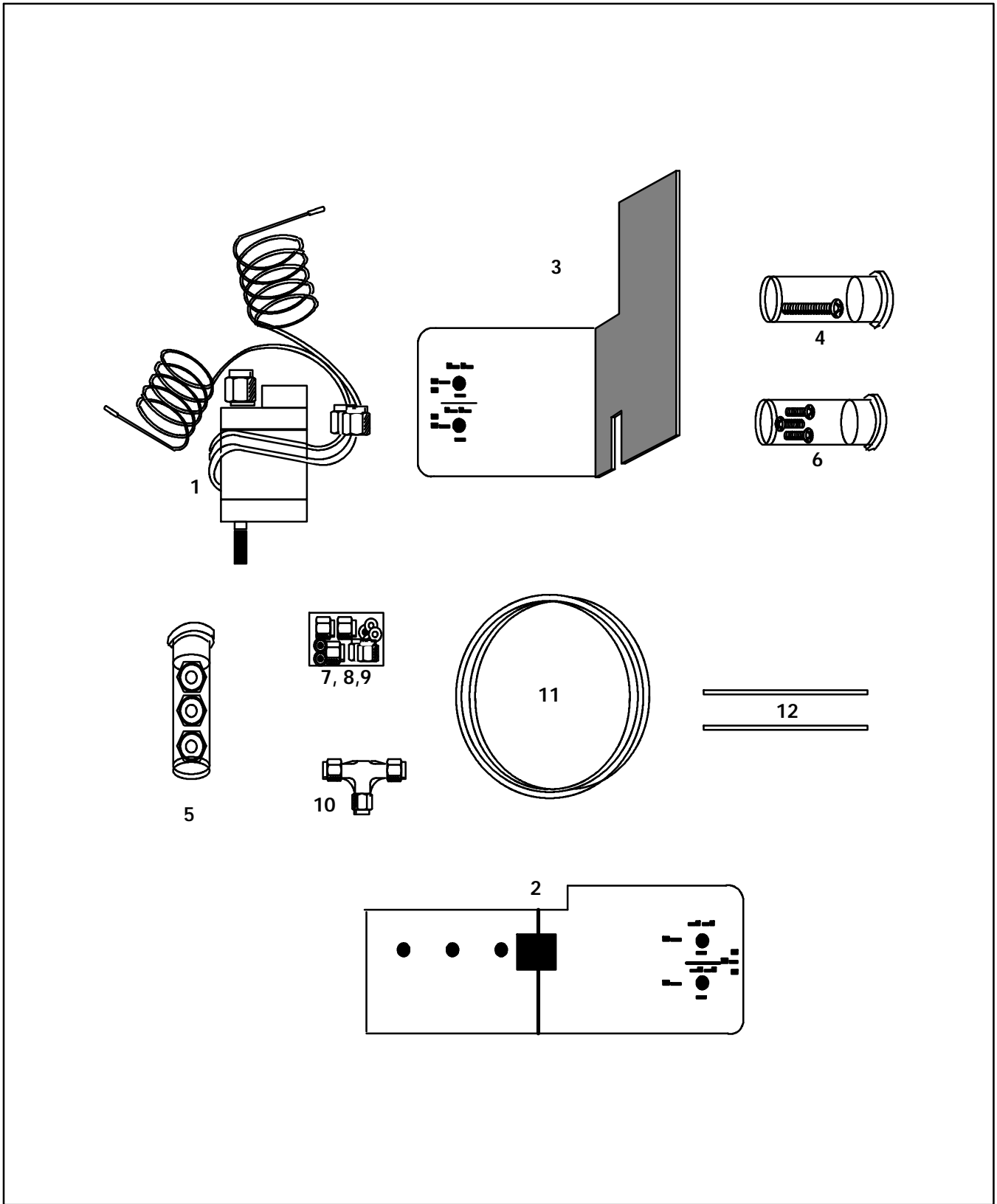

Figure 9. Carrier Gas Miser (CGM), (HP19247B) (Sheet 2 of 2).