

---

Description	HP Part Number
Ion source, complete	05971-60102
body	05971-20128
drawout cylinder	05971-20141
drawout plate	05971-20134
entrance lens (with pin)	05971-20126
filament assembly	05971-60140
ion focus lens (with pin)	05971-20127
lens insulator (pair)	05971-20130
repeller assembly	05971-60170

---

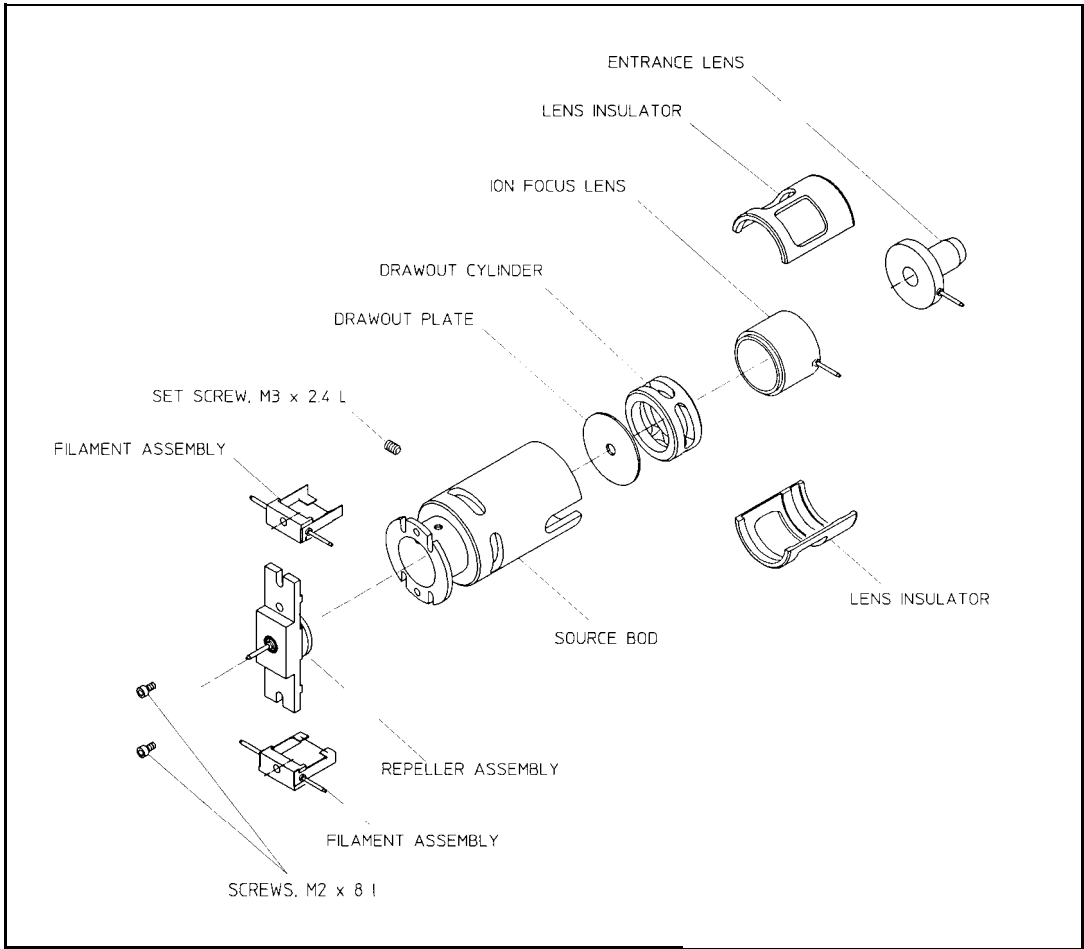

Figure 7-2. Ion source - exploded view