

Item	Description	HP Part No.	Qty.
1	Collector Assembly:	19231- 60690	1
2	● PTFE Chimney (optional)	19231- 21050	1
3	● Collector Nut	19231- 20940	1
4	● Spring Washer	3050- 1246	1
5	● Ignitor Castle or optional hastelloy component*	19231- 20910 19231- 21060	1
6	● Ignitor (Glow Plug) Assembly	19231- 60680	1
7	● Upper Collector Insulator	19231- 20970	1
8	● Collector Body or optional hastelloy component*	19231- 20960 19231- 21080	1
9	● Lower Collector Insulator	19231- 20950	1
10	● Spanner Nut (Collector)	19231- 20980	1
11	● Collector Mount	19231- 20930	1
12	● Collector Housing	19231- 20920	1
13	● Gasket	0905- 0915	1
14	Screw, M4 x 25 mm	0515- 0981	3
15	Jets:		1
—	● Packed Column (0.018- inch id)	18710- 20119	-
—	● Simulated Dist (0.030- inch od)	18789- 80070	-
—	● Capillary Column (0.011- inch id)	19244- 80560	-
16	Base Spanner Nut	19231- 20990	1
17	Thermal Strap	19231- 40050	1
18	J- Clamp	19231- 00040	1
19	Screw, M4 x 8 mm	0515- 0910	8
20	Detector Weldment	19231- 80580	1
21	Heater/Sensor Assembly:	05890- 61140	1
22	● PRT Sensor	19231- 60660	1
23	● Contact	1251- 5963	2
24	● Heater, 70W	19231- 60620	1
25	● Contact	1251- 1679	2
26	● Flexible Sleeving (ordered by the inch)	0890- 0737	22
27	Insulation	19231- 00080	1
28	Insulation Plate	19231- 00090	1
29	Side Shield	19231- 00100	2
30	Diode Bridge Assembly	19231- 60025	1
31	Interconnect Assembly:	19231- 60710	1
32	● Coil Spring	1460- 2142	1
33	Hex Nut, M3 x 0.5	0535- 0004	3
34	Lock Washer	2190- 0407	3
35	Adapters: (Refer to Figure 7)		

* hastelloy components may be employed when analyzing highly corrosive materials.

Figure 2. Flame Ionization Detector (FID) (Sheet 1 of 2).

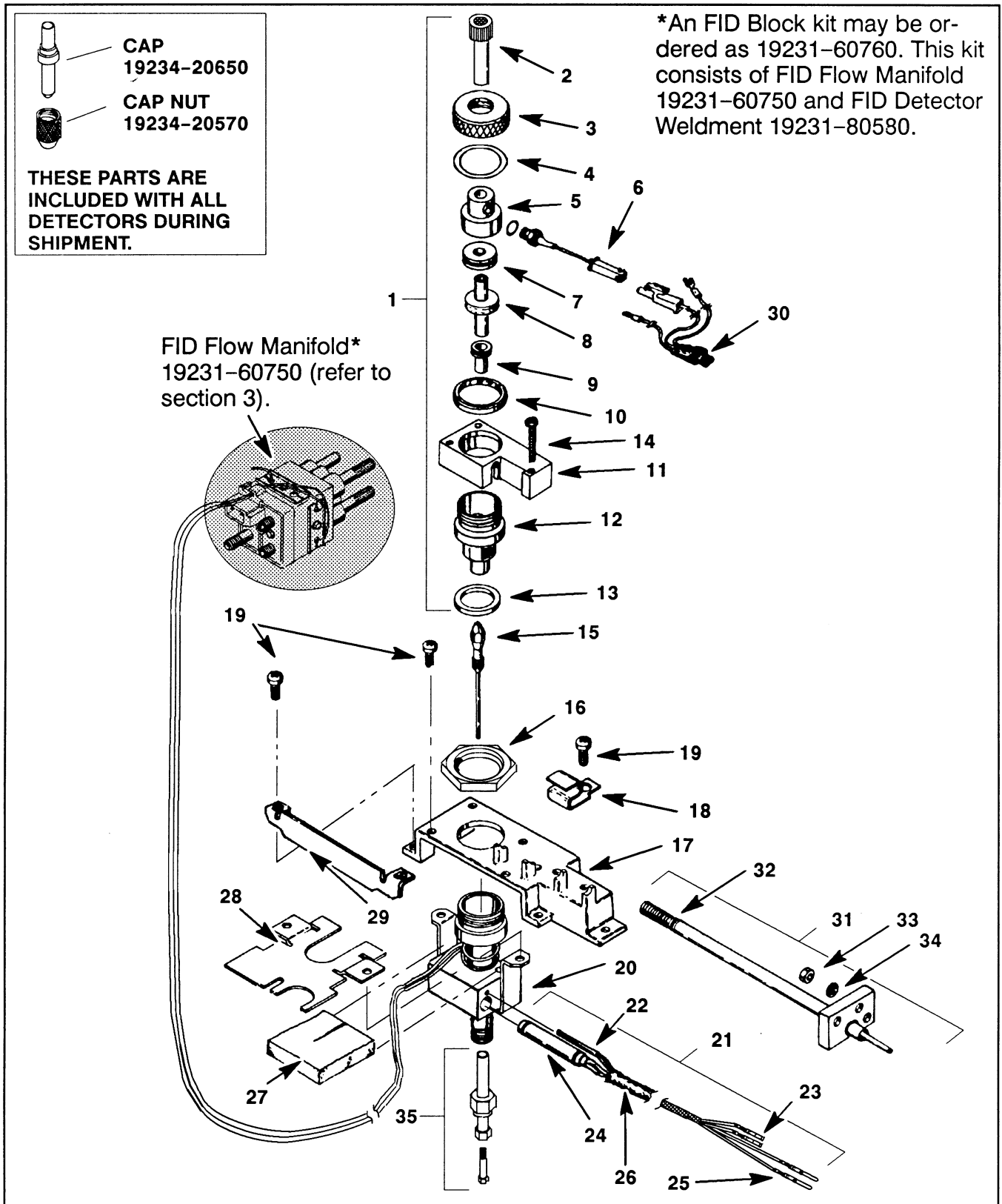

Figure 2. Flame Ionization Detector (FID) (Sheet 2 of 2).