



# AGPROfessionals

DEVELOPERS OF AGRICULTURE

**County Road 6**  
**Brighton, CO**  
**34.37 acres +/-**



**DESCRIPTION:** Excellent parcel of land in a prime Colorado Front Range location! 34 acres ready for your new home build. Magnificent mountain views and access to Denver, Fort Collins and the surrounding areas.

**LOCATION:** From I-25, Exit 232 (Summit Blvd.) east to Colorado Blvd., then south to CR 6 and back east 1.5 miles

**MINERALS:** Seller shall retain all mineral rights

**ZONED:** Ag

**TAXES:** \$95/2020

**LEGAL:** Lot A of Recorded Exemption No. 1469-19-4-RE3489 being part of the South 1/2 of Section 19, Township 1 North, Range 67 West of the 6th P.M. Identified by Weld County Assessors Parcel No. 146919300060 containing 34.37 acres more or less.



**\$974,200**



**RYAN  
HOSTETLER**  
ACCREDITED LAND CONSULTANT

**AGPROS.COM**  
3050 67th Avenue, Greeley, CO

**303.883.7080** **Ryan@Agpros.com**



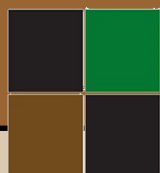
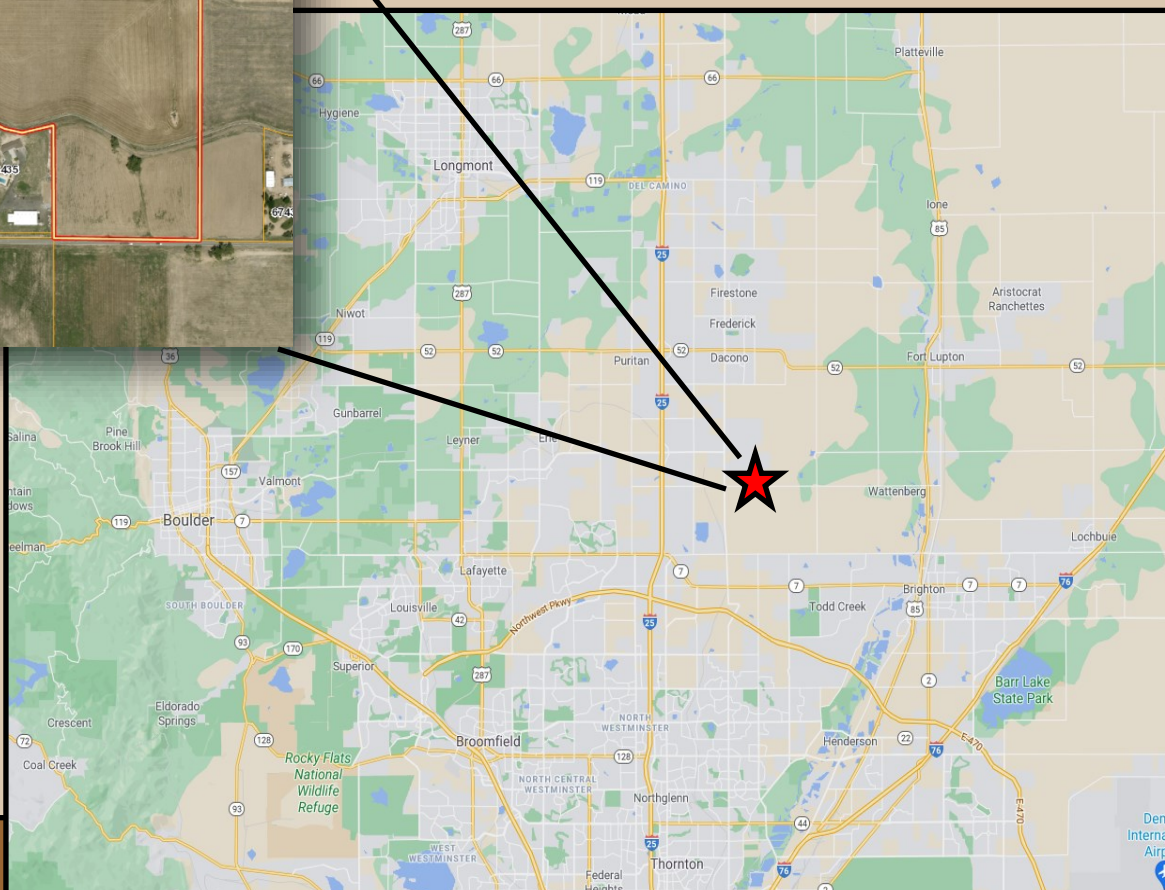

**AGPRO**fessionals  
DEVELOPERS OF AGRICULTURE