



AGPROprofessionals
DEVELOPERS OF AGRICULTURE

County Road 20 Estate Lots

*Fort Lupton, CO
10 acres +/-*



Lot A \$372k
Lot B \$352k
Lot C \$332k

Comments: These 10 acre estate lots are located on CR 20 just east of Firestone and feature great views with no covenants/restrictions. Lots of this size are rare along the Front Range of Colorado. Each lot has 250 AMP service provided by United Power and a Central Weld budget tap has been installed. There is plenty of room for whatever your interests are - from livestock to building a large shop -you can do it all here. Ideal for a new residential build or for obtaining a USR through Weld County for an oil and gas support business/residence. Excellent location just minutes from I-25.

Legal: Lot A, B or C of RECX18-0107 being part of the Southeast 1/4 of 15-2-67

Taxes: \$TBD/2019

Water: Central Weld County Water District budget taps



**RYAN
HOSTETLER**
Accredited Land Consultant

AGPROS.COM
3050 67th Avenue, Greeley, CO

303.883.7080 Ryan@Agpros.com

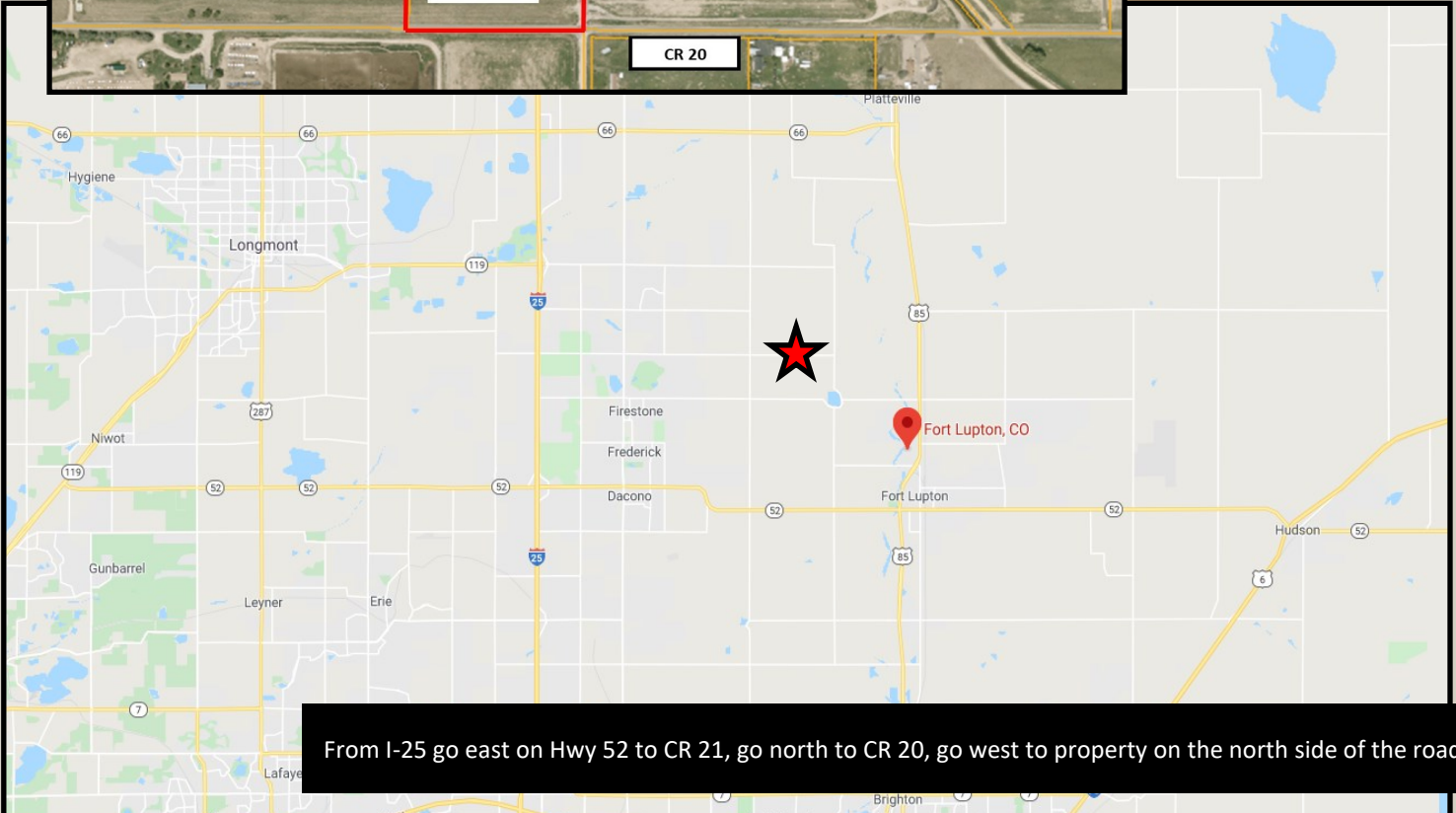

From I-25 go east on Hwy 52 to CR 21, go north to CR 20, go west to property on the north side of the road.



AGPROprofessionals
DEVELOPERS OF AGRICULTURE