



- ☒ **Steel**

-0.188 Wall (3/16") Steel On ALL Products

56% Thicker than 0.120 AKA 11 Gauge
- ☒ **Powder Coating**

-Hybrid Texture Powder Coating For

Increased Durability
- ☐ **Upholstery / Padding**

-Double Stitched Seams

-3/4" Plywood

-T-Nut Fasteners

-1" Super Dense Closed Cell Neoprene Padding
- ☐ **Lineal Ball Bearings**

-Precision Ground Steel Sealed 1", 1.25", & 1.5"

Riding on Rockwall 60 Shafting
- ☐ **Solid Oak**

-3/4" Solid Tongue & Groove
- ☐ **Stainless Steel**

-On ALL Adjustable Parts
- ☐ **Weight Stacks**

-1" Solid Round Guide Rod

w/Industrial Chrome Plating

-100% Steel Selectorized

Weight Stack Plates
- ☒ **Custom Colors Available**
- ☒ **Custom Designs Available**

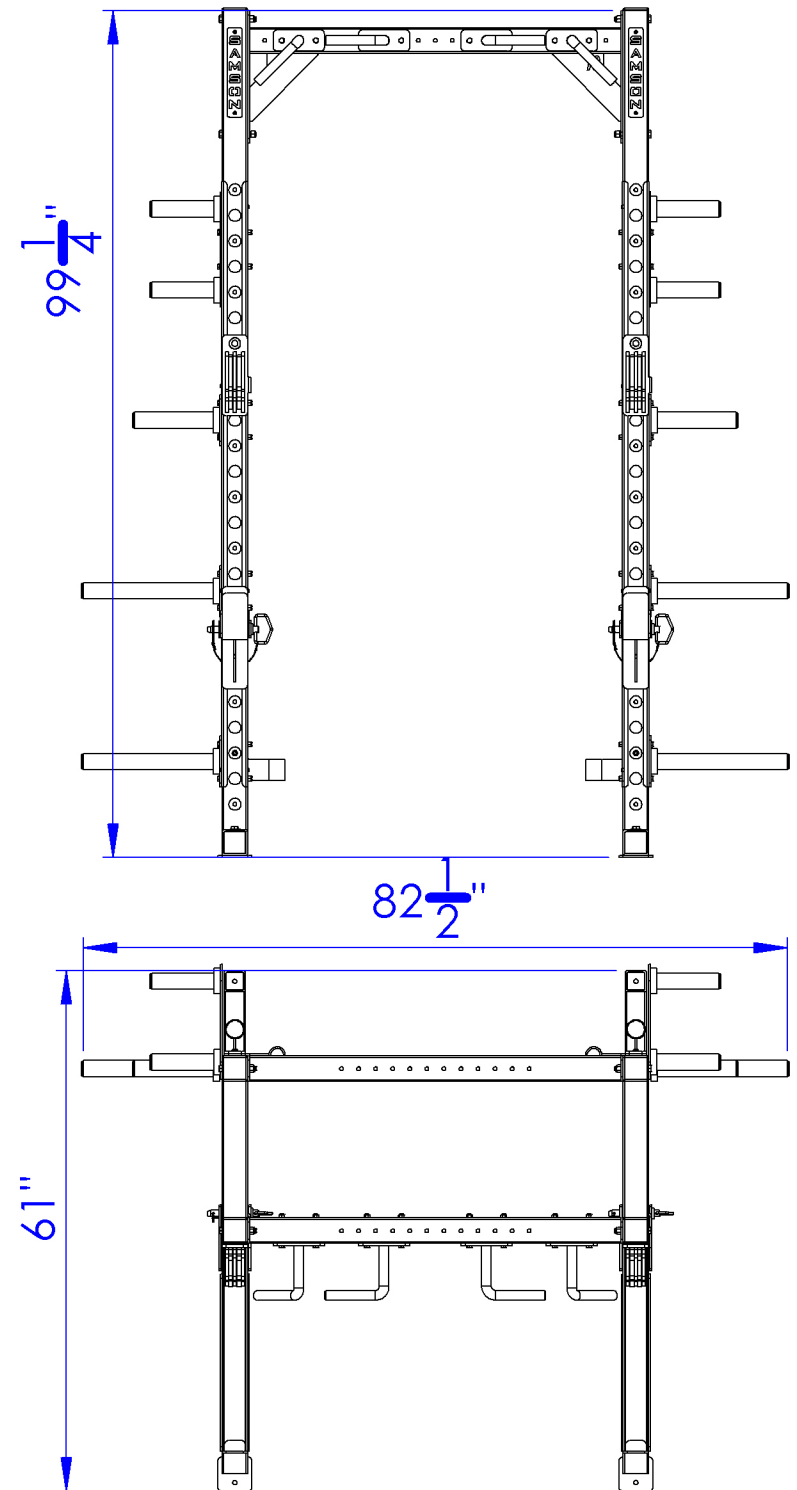

<div>Product # 111MSSL</div>	<div>SAFETY RACK</div>	
<div>Product Weight: 435lb</div>		
<div>Samson Equipment, Inc. 1-800-4-SAMSON samsonequipment.com</div>		