

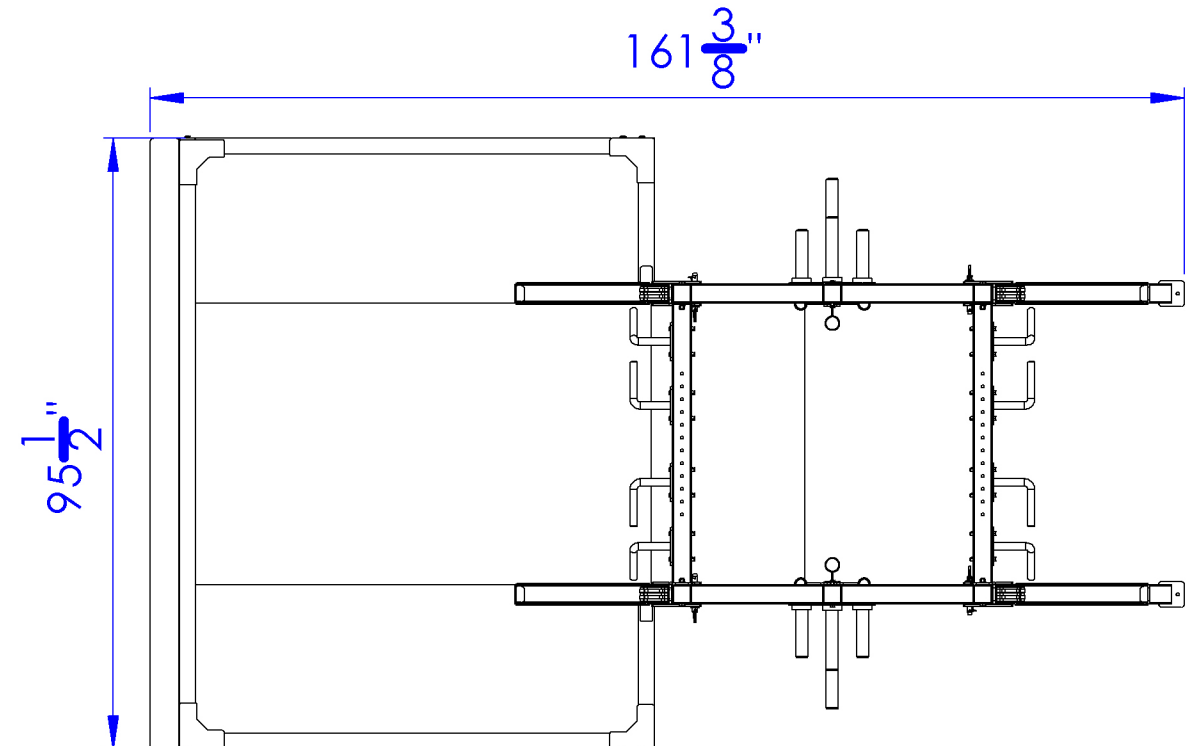

- ☒ **Steel**
 - 0.188 Wall (3/16") Steel On ALL Products
 - 56% Thicker than 0.120 AKA 11 Gauge
- ☒ **Powder Coating**
 - Hybrid Texture Powder Coating For Increased Durability
- ☐ **Upholstery / Padding**
 - Double Stitched Seams
 - 3/4" Plywood
 - T-Nut Fasteners
 - 1" Super Dense Closed Cell Neoprene Padding
- ☐ **Lineal Ball Bearings**
 - Precision Ground Steel Sealed 1", 1.25", & 1.5"
 - Riding on Rockwall 60 Shafting

- ☒ **Solid Oak**
 - 3/4" Solid Tongue & Groove
- ☐ **Stainless Steel**
 - On ALL Adjustable Parts
- ☐ **Weight Stacks**
 - 1" Solid Round Guide Rod w/Industrial Chrome Plating
 - 100% Steel Selectorized Weight Stack Plates
- ☒ **Custom Colors Available**
- ☒ **Custom Designs Available**

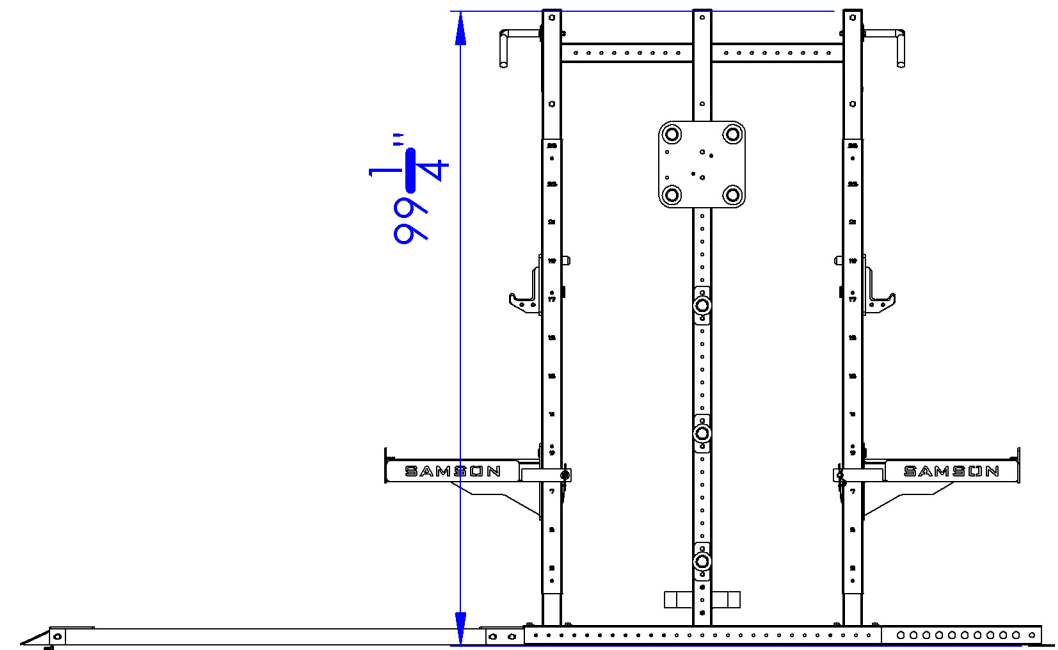

Product #
111PSHHD

Product Weight:
1036lb

Samson Equipment, Inc.
1-800-4-SAMSON
samsonequipment.com

Double Power Station

