

☒ **Steel**

- 0.188 Wall (3/16") Steel On ALL Products
- 56% Thicker than 0.120 AKA 11 Gauge

☒ **Powder Coating**

- Hybrid Texture Powder Coating For Increased Durability

☐ **Upholstery / Padding**

- Double Stitched Seams
- 3/4" Plywood
- T-Nut Fasteners
- 1" Super Dense Closed Cell Neoprene Padding

☐ **Steel Sealed Ball Bearings**

- Precision Ground Steel Sealed 1", 1.25", & 1.5" Riding on Rockwall 60 Shafting

☐ **Solid Oak**

- 3/4" Solid Tongue & Groove

☒ **Stainless Steel**

- On ALL Adjustable Parts

☒ **Weight Stacks**

- 1" Solid Round Guide Rod w/Industrial Chrome Plating
- 100% Steel Selectorized Weight Stack Plates

☒ **Custom Colors Available**

☒ **Custom Designs Available**

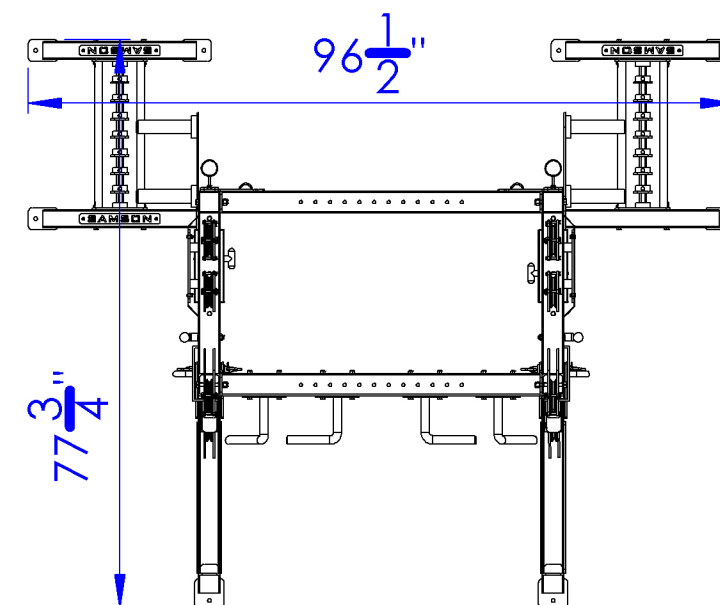
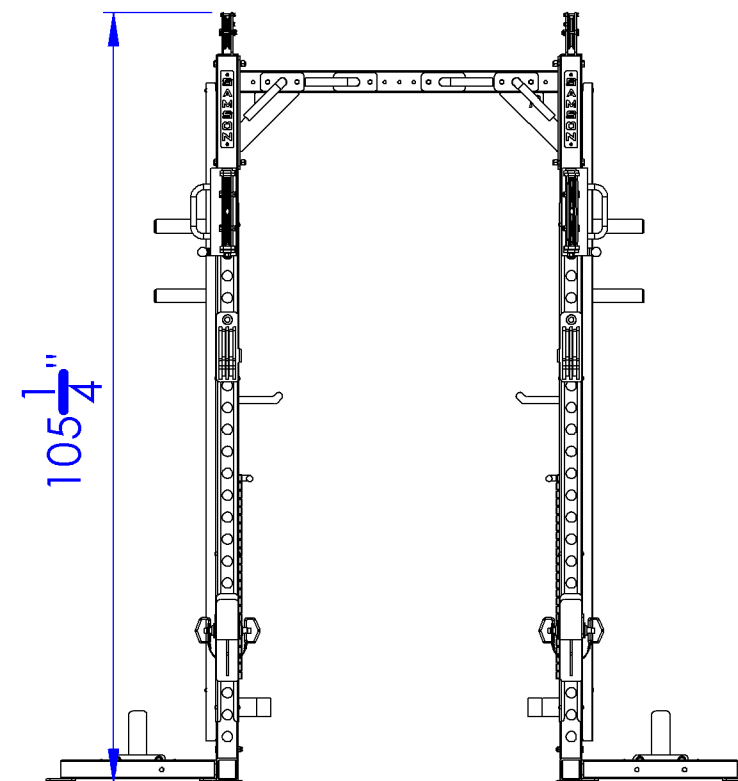

Product #
FTR111MSSL

Product Weight:
1466lb

Samson Equipment, Inc.
1-800-4-SAMSON
samsonequipment.com

FTR w/ 206

(FUNCTIONAL TRAINING RACK)

