

TEREX SK 575-32  
262.5' MAX JIB REACH @ 8590 LBS.  
HOOK HEIGHT TO BE VERIFIED @ 206.7'

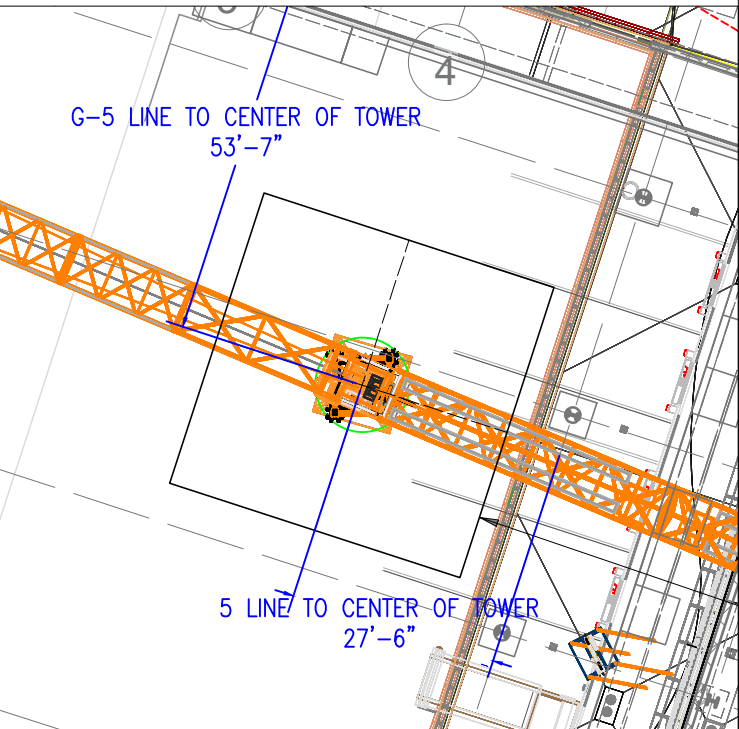
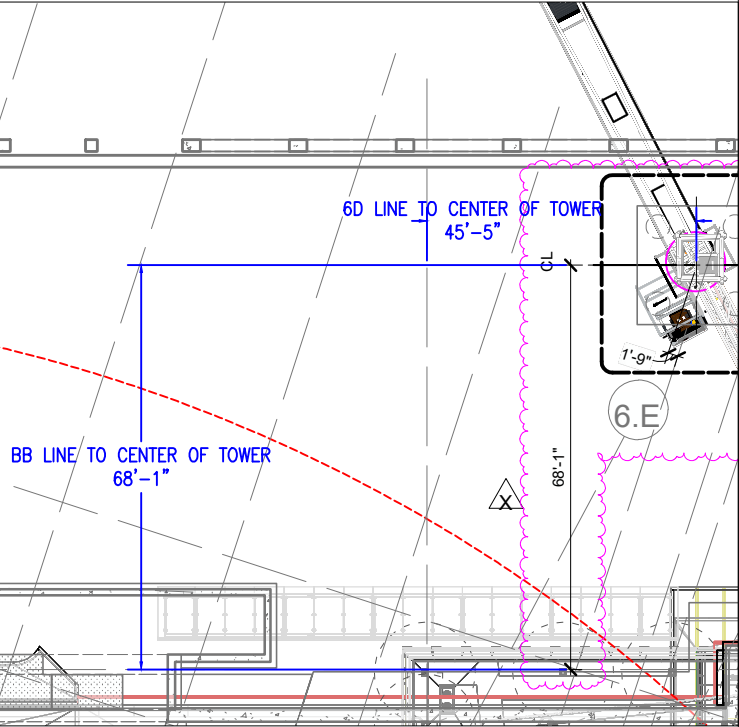

EXISTING UCI ICMC PROJECT  
LIEBHERR 630 EC-H-20  
267' MAX JIB REACH @ 12,790 LBS.  
CURRENT JIB SET AT 267'  
HOOK HEIGHT TO BE VERIFIED @ 176'

**MR. CRANE**

LIFTING AND RIGGING SOLUTIONS  
647 NORTH HARITON STREET . ORANGE, CALIFORNIA 92668-1311  
PHONE: 714/633-2100 FAX: 714/633-6901  
FED I.D. NO. 95-3007071 A California Corporation

This document is the sole property of Mr. Crane Inc. and is to be used only by them in the execution of their work. It is lent to the borrower for his / her confidential use only. In consideration of the loan of this document, the borrower promises and agrees to return it upon request without being reproduced, copied, lent, or used for any purpose other than that for which it is furnished. These documents are not represented as third-party engineering products. They are the property of MCI and are issued only in conjunction with the work to be performed by MCI. This document is not to be used by others without the expressed written consent of MCI and releasing MCI of all responsibility. No liability or assumption of risk will be accepted by MCI for the unauthorized use of these documents. Weights, dimensions, and other information used in producing this document may have been furnished by others, and is assumed to be the most accurate information. MCI is not responsible for the accuracy supplied by others. MCI's advice and assistance is given in good faith, but without responsibility. All documents are preliminary until accepted by customer.

1	6.10.22	ISSUE FOR REVIEW
2	6.11.22	TOWER HEIGHT REVISION AND REVIEW
3	7.6.22	TOWER HEIGHT REVISION SK575-32
4	10.13.22	ADDED DIM/ADJUST TC LOC/NO TSK/FINAL
5	12.28.22	ADDED EXISTING 630 TC
No.	Date	Revision

Project:  
UCI ICMC PHASE II  
TC NORTH & TC SOUTH  
HENSEL PHELPS

Date: 6.10.22

Drawn By: MPS

Scale: NTS

Dwg Title:  
LIEBHERR 630 EC-H-20 - JIB RADIUS 267'  
TEREX SK 575-32 RADIUS 262.5'  
SITE PLAN LAYOUT

Dwg No.: MC50365TC

Sht No.: 1



LIFT PLAN TO BE  
APPROVED BY CUSTOMER

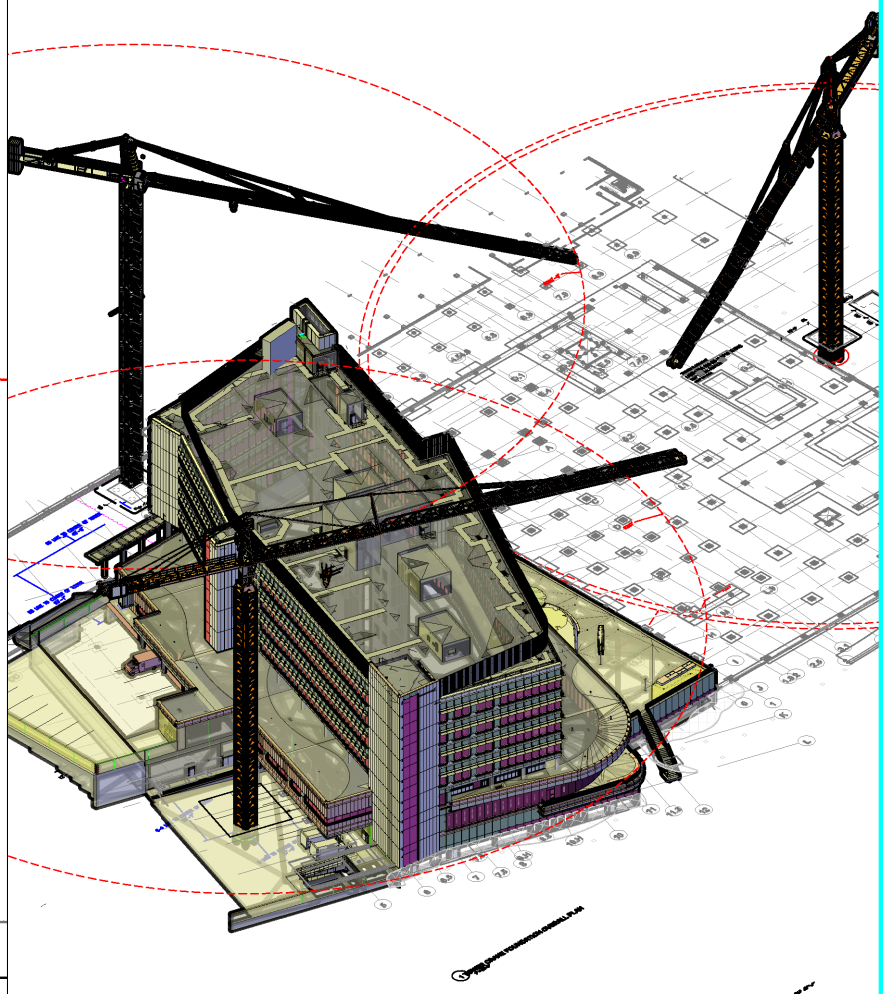
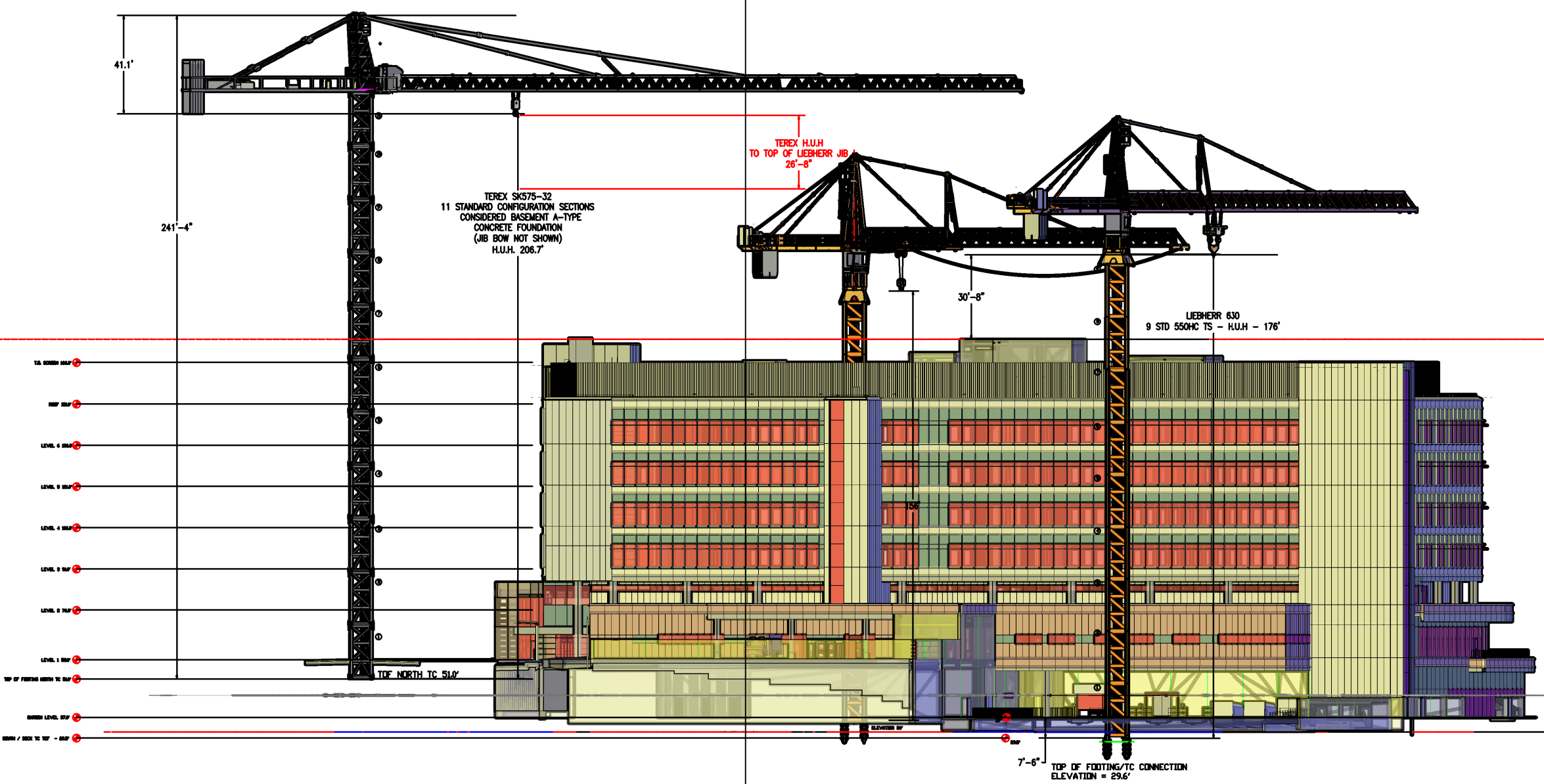

**MR. CRANE**

LIFTING AND RIGGING SOLUTIONS  
647 NORTH HARITON STREET . ORANGE, CALIFORNIA 92868-1311  
PHONE: 714/633-2100 FAX: 714/633-6901  
FED I.D. NO. 95-3007071 A California Corporation

This document is the sole property of Mr. Crane Inc. and is to be used only by them in the execution of their work. It is lent to the borrower for his / her confidential use only. In consideration of the loan of this document, the borrower promises and agrees to return it upon request without being reproduced, copied, lent, or used for any purpose other than that for which it is furnished. These documents are not represented as third-party engineering products. They are the property of MCI and are issued only in conjunction with the work to be performed by MCI. This document is not to be used by others without the expressed written consent of MCI and releasing MCI of all responsibility. No liability or assumption of risk will be accepted by MCI for the unauthorized use of these documents. Weights, dimensions, and other information used in producing this document may have been furnished by others, and is assumed to be the most accurate information. MCI is not responsible for the accuracy supplied by others. MCI's advice and assistance is given in good faith, but without responsibility. All documents are preliminary until accepted by customer.

1	6.10.22	ISSUE FOR REVIEW
2	6.11.22	TOWER HEIGHT REVISION AND REVIEW
3	7.6.22	TOWER HEIGHT REVISION SK575-32
4	10.13.22	ADDED DIM/ADJUST TC LOC/NO TSK/FINAL
5	12.28.22	ADDED EXISTING 630 TC
No.	Date	Revision

Project:

UCI ICMC PHASE II  
TC NORTH & TC SOUTH  
HENSEL PHELPS

Date: 6.10.22 Drawn By: MPS Scale: NTS

Dwg Title:

LIEBHERR 630 EC-H-20 - JIB RADIUS 267'  
TEREX SK 575-32 RADIUS 262.5'  
SITE PLAN LAYOUT

Dwg No.: MC50365TC Sht No.: 2

TEREX SK 575-32  
262.5' MAX JIB REACH @ 8590 LBS.  
HOOK HEIGHT TO BE VERIFIED



Radius	262'-6" (L9) Jib	
	2-Part (lbs)	4-Part (lbs)*
39'-4"	35,270	70,540
49'-2"	35,270	63,710
59'-1"	35,270	50,920
68'-11"	35,270	42,100
75'-6"	35,270	37,470
82'-0"	35,270	33,730
91'-10"	32,840	29,100
98'-5"	30,200	26,450
111'-7"	26,230	22,480
114'-10"	25,350	21,600
121'-5"	23,580	19,840
127'-11"	22,260	18,510
131'-3"	21,600	17,850
141'-1"	19,620	16,090
144'-4"	19,180	15,430
147'-8"	18,510	14,990
154'-2"	17,630	13,880
160'-9"	16,750	13,000
164'-0"	16,310	12,560
173'-11"	15,210	11,460
177'-2"	14,770	11,020
180'-5"	14,550	10,800
187'-0"	13,880	10,140
193'-7"	13,220	9,470
196'-10"	12,780	9,250
203'-5"	12,340	8,590
210'-0"	11,900	8,150
213'-3"	11,460	7,930
223'-1"	10,800	7,270
226'-5"	10,580	7,050
229'-8"	10,360	6,830
236'-3"	10,140	6,390
242'-9"	9,700	5,950
246'-1"	9,470	5,730
252'-7"	9,030	5,510
259'-2"	8,810	5,070
262'-6"	8,590	-

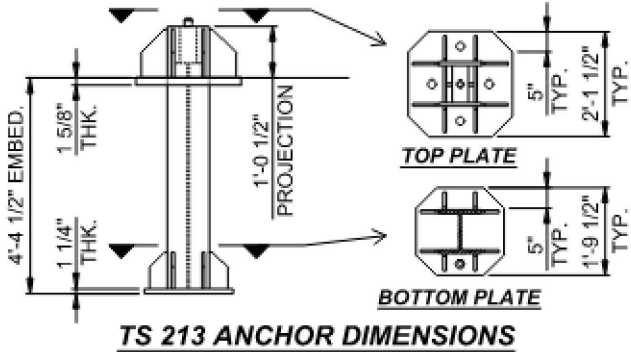

EXISTING UCI ICMC PROJECT  
LIEBHERR 630 EC-H-20  
267' MAX JIB REACH @ 12,790 LBS.  
CURRENT JIB SET AT 267'

LIEBHERR 630 EC-H 20 Litronic®

2-Part Line	Hook Radius	Jib tip Radius	Maximum Capacity – Radius	ft m	10 3.1	49 15	66 20	82 25	98 30	123 37.4	148 45	162 49.4	180 55	201 61.4	213 65	234 71.4	246 75	267 81.4
	267 ft 81.4m	274'-3" 83.6m	44,090 lbs – 88 ft 20 000 kg – 26.73m	lbs kg	44,090 20 000	44,090 20 000	44,090 20 000	44,090 20 000	39,040 17 710	30,750 13 950	24,980 11 330	22,400 10 160	19,710 8 940	17,220 7 810	16,030 7 270	14,200 6 440	13,290 6 030	11,900 5 400
	234 ft 71.4m	241'-6" 73.6m	44,090 lbs – 100 ft 20 000 kg – 30.54m	lbs kg	44,090 20 000	44,090 20 000	44,090 20 000	44,090 20 000	44,090 20 000	35,540 16 120	28,970 13 140	26,060 11 820	23,020 10 440	20,170 9 150	18,830 8 540	16,760 7 600		
	201 ft 61.4m	208'-8" 63.6m	44,090 lbs – 106 ft 20 000 kg – 32.28m	lbs kg	44,090 20 000	44,090 20 000	44,090 20 000	44,090 20 000	44,090 20 000	37,830 17 160	30,890 14 010	27,820 12 620	24,580 11 150	21,610 9 800				
	162 ft 49.4m	169'-4" 51.6m	44,090 lbs – 113 ft 20 000 kg – 34.41m	lbs kg	44,090 20 000	44,090 20 000	44,090 20 000	44,090 20 000	44,090 20 000	40,370 18 310	33,030 14 980	29,760 13 500						
	123 ft 37.4m	129'-11" 39.6m	44,090 lbs – 119 ft 20 000 kg – 36.16m	lbs kg	44,090 20 000	44,090 20 000	44,090 20 000	44,090 20 000	44,090 20 000	42,550 19 300								
																		LM1
2-Part Line	267 ft 81.4m	274'-3" 83.6m	44,090 lbs – 93 ft 20 000 kg – 28.22m	lbs kg	44,090 20 000	44,090 20 000	44,090 20 000	44,090 20 000	41,360 18 760	32,630 14 800	26,540 12 040	23,830 10 810	21,010 9 530	18,390 8 340	17,130 7 770	15,210 6 900	14,260 6 470	12,790 5 800
	234 ft 71.4m	241'-6" 73.6m	44,090 lbs – 106 ft 20 000 kg – 32.19m	lbs kg	44,090 20 000	44,090 20 000	44,090 20 000	44,090 20 000	44,090 20 000	37,590 17 050	30,690 13 920	27,650 12 540	24,430 11 080	21,450 9 730	20,040 9 090	17,860 8 100		
	201 ft 61.4m	208'-8" 63.6m	44,090 lbs – 113 ft 20 000 kg – 34.37m	lbs kg	44,090 20 000	44,090 20 000	44,090 20 000	44,090 20 000	44,090 20 000	40,300 18 280	32,980 14 960	29,720 13 480	26,300 11 930	23,150 10 500				
	162 ft 49.4m	169'-4" 51.6m	44,090 lbs – 119 ft 20 000 kg – 36.26m	lbs kg	44,090 20 000	44,090 20 000	44,090 20 000	44,090 20 000	44,090 20 000	42,660 19 350	34,940 15 850	31,530 14 300						
	123 ft 37.4m	129'-11" 39.6m	44,090 lbs – 123 ft 20 000 kg – 37.4m	lbs kg	44,090 20 000	44,090 20 000	44,090 20 000	44,090 20 000	44,090 20 000	44,090 20 000								LM2

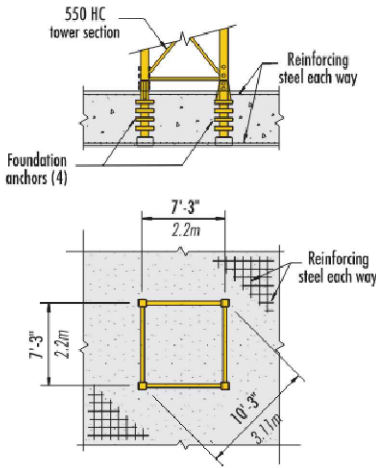

with 550 HC Tower Section  
on concrete slab

LIFT PLAN TO BE  
APPROVED BY CUSTOMER

MR. CRANE

LIFTING AND RIGGING SOLUTIONS  
647 NORTH HARITON STREET . ORANGE, CALIFORNIA 92868-1311  
PHONE: 714/633-2100 FAX: 714/633-6901  
FED I.D. NO. 95-3007071 A California Corporation

This document is the sole property of Mr. Crane Inc. and is to be used only by them in the execution of their work. It is lent to the borrower for his / her confidential use only. In consideration of the loan of this document, the borrower promises and agrees to return it upon request without being reproduced, copied, lent, or used for any purpose other than that for which it is furnished. These documents are not represented as third-party engineering products. They are the property of MCI and are issued only in conjunction with the work to be performed by MCI. This document is not to be used by others without the expressed written consent of MCI and releasing MCI of all responsibility. No liability or assumption of risk will be accepted by MCI for the unauthorized use of these documents. Weights, dimensions, and other information used in producing this document may have been furnished by others, and is assumed to be the most accurate information. MCI is not responsible for the accuracy supplied by others. MCI's advice and assistance is given in good faith, but without responsibility. All documents are preliminary until accepted by customer.

1	6.10.22	ISSUE FOR REVIEW
2	6.11.22	TOWER HEIGHT REVISION AND REVIEW
3	7.6.22	TOWER HEIGHT REVISION SK575-32
4	10.13.22	ADDED DIM/ADJUST TC LOC/NO TSK/FINAL
5		
No.	Date	Revision

Project:

UCI ICMC PHASE II  
TC NORTH & TC SOUTH  
HENSEL PHELPS

Date:	6.10.22	Drawn By:	MPS	Scale:	NTS	Dwg No.:	MC50365TC	Sht No.:	3
-------	---------	-----------	-----	--------	-----	----------	-----------	----------	---

Dwg Title:

LIEBHERR 630 EC-H-20 - JIB RADIUS 267'  
TEREX SK 575-32 RADIUS 262.5'  
SITE PLAN LAYOUT